



MAKE WORK
LIFE EASIER



INTELLIGENT
TORCH SOLUTIONS

ARC M SERIES



A Passion for Technology & Innovation

To produce hand tools that reach the pinnacle of performance, durability and functionality you have to be passionate about what you do.

At Arc Torchology the research and development department is the beating heart of our company.

Every single component is conceived, developed, manufactured and tested in-house.

Our development and testing activities are loaded with cutting edge technologies, many of which have been developed specifically by us to meet the very stringent demands we place on our design solutions.

These specialized, bespoke solutions allow us to develop products that surpass the prerequisite of industry standards, inventing increasingly more beneficial products that deliver maximum results for the operator.

This is not business as usual.

FEATURING NEW TECHNOLOGIES



find out more arctorchology.com

Contents

	Arc M Range Overview and Ratings	2
	Torch Range	
Industrial Air-Cooled Series	M1	8
	M18	10
	M2	12
	M22	14
Industrial Air-Cooled Series - Multijust	M2M	16
	M22M	18
High Performance Air-Cooled Series	M3	20
	M4	22
	M5	24
	M6	26
High Performance Liquid-Cooled Series	M5W	28
	M55W	30
	M65W/M65WS	32
	M65WLP	34
High Performance Liquid-Cooled Auto Series	M65WA Auto New	36
	Wear Parts	
	Industrial Series	38
	High Performance Series	40

AIR-COOLED

Arc M Industrial Mig Series



MAKE WORK
LIFE EASIER

TECHNICAL SPECIFICATIONS

IEC/EN 60974-7

M1

Cooling Method	Air-Cooled	
Rating:	CO ₂	180A
	Mixed Gas M21	150A
Duty Cycle	60%	
Wire Size	0.6-1.0mm	

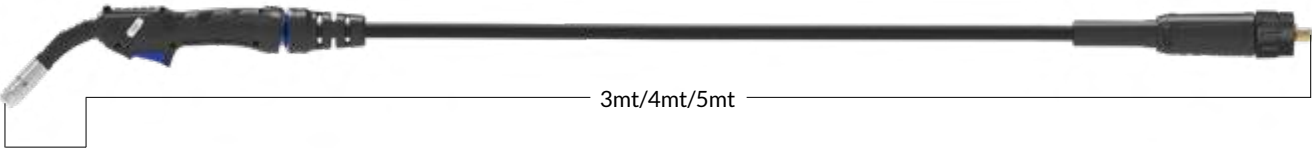

M18

Cooling Method	Air-Cooled	
Rating:	CO ₂	210A
	Mixed Gas M21	180A
Duty Cycle	60%	
Wire Size	0.6-1.0mm	

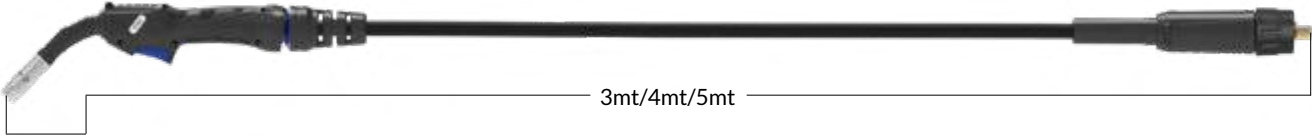

M2

Cooling Method	Air-Cooled	
Rating:	CO ₂	230A
	Mixed Gas M21	200A
	Pulse	110A
Duty Cycle	60%	
Wire Size	0.8-1.2mm	



M2 Video



M22

Cooling Method	Air-Cooled	
Rating:	CO ₂	250A
	Mixed Gas M21	220A
	Pulse	120A
Duty Cycle	60%	
Wire Size	0.8-1.2mm	



AIR-COOLED

Arc M Industrial Mig Series - Multijust



MAKE WORK
LIFE EASIER

M2M Multijust

Cooling Method	Air-Cooled	
Rating:	CO ₂	230A
	Mixed Gas M21	200A
	Pulse	110A
Duty Cycle	60%	
Wire Size	0.8-1.2mm	

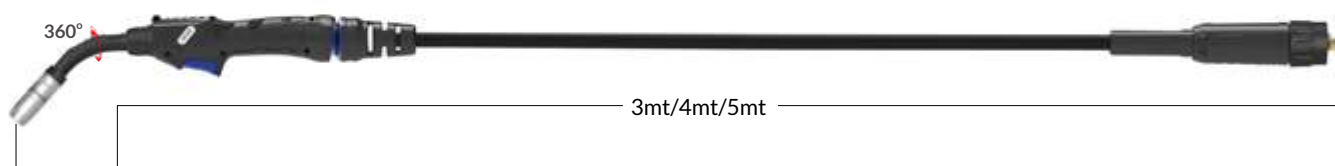

M22M Multijust

Cooling Method	Air-Cooled	
Rating:	CO ₂	250A
	Mixed Gas M21	220A
	Pulse	120A
Duty Cycle	60%	
Wire Size	0.8-1.2mm	

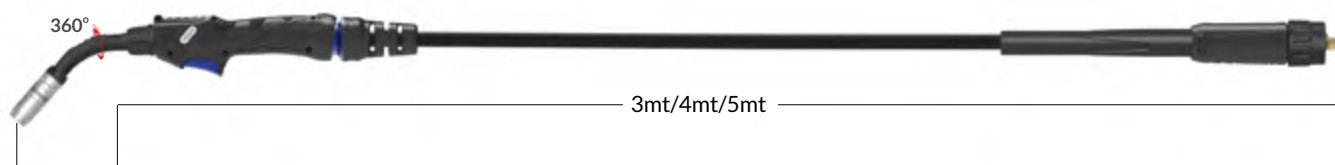

AIR-COOLED

Arc M High Performance Mig Series



MAKE WORK
LIFE EASIER

M3

Cooling Method	Air-Cooled	Max. Load
CO ₂	300A	10.5KW
Rating: Mixed Gas M21	270A	8.9KW
Duty Cycle	60%	
Wire Size	0.9-1.2mm	

Standard: EN 50078

Cooling Method	Air-Cooled
CO ₂	340A
Rating: Mixed Gas M21	325A
Duty Cycle	60%
Wire Size	0.9-1.2mm



Rated using power source with VDE standard volt/amp characteristic ($U=14+0.05xI$).

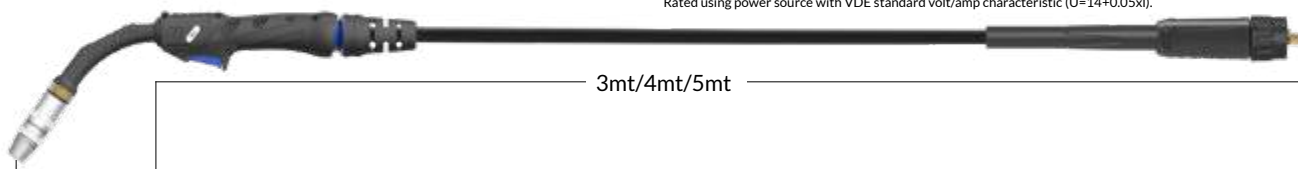

M4

Cooling Method	Air-Cooled	Max. Load
CO ₂	350A	14.1KW
Rating: Mixed Gas M21	320A	11.4KW
Duty Cycle	60%	
Wire Size	0.9-1.2mm	

Standard: EN 50078

Cooling Method	Air-Cooled
CO ₂	410A
Rating: Mixed Gas M21	380A
Duty Cycle	60%
Wire Size	0.9-1.2mm



Rated using power source with VDE standard volt/amp characteristic ($U=14+0.05xI$).

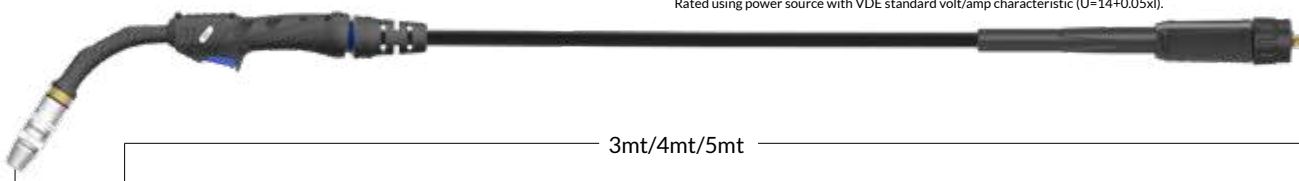

M5

Cooling Method	Air-Cooled	Max. Load
CO ₂	390A	14.6KW
Rating: Mixed Gas M21	360A	12.2KW
Duty Cycle	60%	
Wire Size	0.9-1.6mm	

Standard: EN 50078

Cooling Method	Air-Cooled
CO ₂	420A
Rating: Mixed Gas M21	375A
Duty Cycle	60%
Wire Size	0.9-1.6mm



M5 Video

Rated using power source with VDE standard volt/amp characteristic ($U=14+0.05xI$).

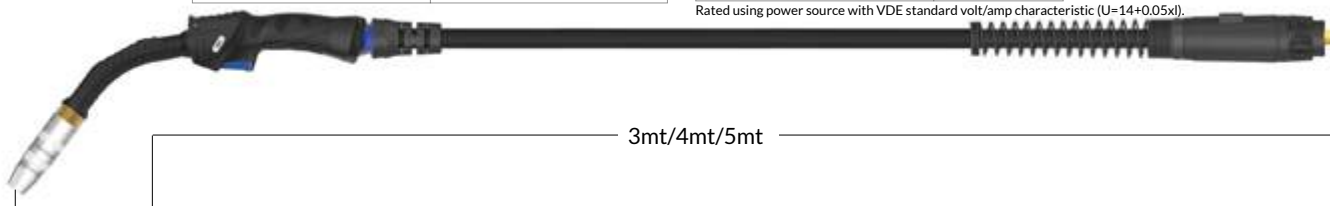

M6

Cooling Method	Air-Cooled	Max. Load
CO ₂	430A	17.6KW
Rating: Mixed Gas M21	400A	14.8KW
Duty Cycle	60%	
Wire Size	0.9-2.0mm	

Standard: EN 50078

Cooling Method	Air-Cooled
CO ₂	470A
Rating: Mixed Gas M21	420A
Duty Cycle	60%
Wire Size	0.9-2.0mm



Rated using power source with VDE standard volt/amp characteristic ($U=14+0.05xI$).

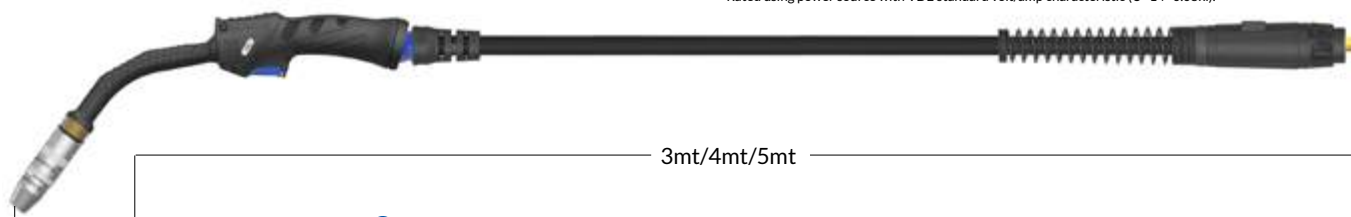

LIQUID-COOLED

Arc M High Performance Mig Series



MAKE WORK
LIFE EASIER

M5W

Cooling Method	Liquid-Cooled			
	Cooler Rating	Max. A	Pulse	Max. Load
Rating: CO ₂	1600W	560A	-	24KW
	1200W	540A	-	22KW
	1000W	510A	-	20KW
Rating: Mixed Gas M21	1600W	540A	380A	22KW
	1200W	520A	350A	21KW
	1000W	500A	340A	19.5KW
Duty Cycle		100%	100%	
Wire Size	Filler Wires	Fe, Fe-MC / FC		0.9-1.6mm
	Filler Wires	Ss, Ss-MC / FC		0.9-1.6mm
	Filler Wires	Al		1.0-1.6mm
Minimum Liquid Flow Rate		1.5 l/min	Important: Please note minimum inlet pressure and flow rate. Low pressure will affect torch performance	
Minimum Liquid Inlet Pressure		2.5 Bar		
Maximum Liquid Inlet Pressure		5.0 Bar		
Maximum Liquid Inlet Temperature		50°C		
Operating Temperature Range		-10...+40°C		



M5W Video

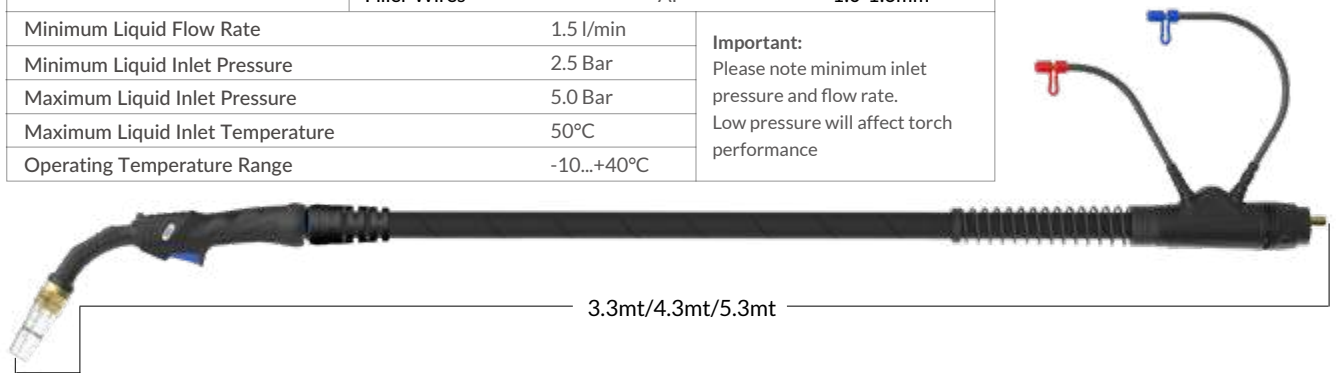

M55W

Cooling Method	Liquid-Cooled			
	Cooler Rating	Max. A	Pulse	Max. Load
Rating: CO ₂	1600W	580A	-	25KW
	1200W	550A	-	23KW
	1000W	520A	-	21KW
Rating: Mixed Gas M21	1600W	560A	400A	23KW
	1200W	530A	360A	21.5KW
	1000W	510A	350A	20KW
Duty Cycle		100%	100%	
Wire Size	Filler Wires	Fe, Fe-MC / FC		0.9-2.0mm
	Filler Wires	Ss, Ss-MC / FC		0.9-1.6mm
	Filler Wires	Al		1.0-2.0mm
Minimum Liquid Flow Rate		1.5 l/min	Important: Please note minimum inlet pressure and flow rate. Low pressure will affect torch performance	
Minimum Liquid Inlet Pressure		2.5 Bar		
Maximum Liquid Inlet Pressure		5.0 Bar		
Maximum Liquid Inlet Temperature		50°C		
Operating Temperature Range		-10...+40°C		



LIQUID-COOLED

Arc M High Performance Mig Series



MAKE WORK
LIFE EASIER

M65W/M65WS

Cooling Method	Liquid-Cooled			
	Cooler Rating	Max. A	Pulse	Max. Load
Rating: CO ₂	1600W	580A	-	25KW
	1200W	550A	-	23KW
	1000W	520A	-	21KW
Rating: Mixed Gas M21	1600W	560A	400A	23KW
	1200W	530A	360A	21.5KW
	1000W	510A	350A	20KW
Duty Cycle		100%	100%	
Wire Size	Filler Wires	Fe, Fe-MC / FC		0.9-2.0mm
	Filler Wires	Ss, Ss-MC / FC		0.9-1.6mm
	Filler Wires	Al		1.0-2.0mm
Minimum Liquid Flow Rate		1.5 l/min	Important: Please note minimum inlet pressure and flow rate. Low pressure will affect torch performance	
Minimum Liquid Inlet Pressure		2.5 Bar		
Maximum Liquid Inlet Pressure		5.0 Bar		
Maximum Liquid Inlet Temperature		50°C		
Operating Temperature Range		-10...+40°C		



3.3mt/4.3mt/5.3mt

M65WLP

Cooling Method	Liquid-Cooled			
	Cooler Rating	Max. A	Pulse	Max. Load
Rating: CO ₂	1600W	590A	-	26KW
	1200W	560A	-	24KW
	1000W	530A	-	22KW
Rating: Mixed Gas M21	1600W	570A	420A	24KW
	1200W	530A	380A	22KW
	1000W	500A	360A	19.5KW
Duty Cycle		100%	100%	
Wire Size	Filler Wires	Fe, Fe-MC / FC		0.9-2.0mm
	Filler Wires	Ss, Ss-MC / FC		0.9-1.6mm
	Filler Wires	Al		1.0-2.0mm
Minimum Liquid Flow Rate		1.5 l/min	Important: Please note minimum inlet pressure and flow rate. Low pressure will affect torch performance	
Minimum Liquid Inlet Pressure		2.5 Bar		
Maximum Liquid Inlet Pressure		5.0 Bar		
Maximum Liquid Inlet Temperature		50°C		
Operating Temperature Range		-10...+40°C		

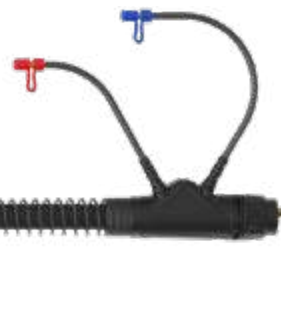

3.3mt/4.3mt/5.3mt

LIQUID-COOLED

Arc M High Performance Mig Series



MAKE WORK
LIFE EASIER

M65WA Auto

Cooling Method	Liquid-Cooled			
	Cooler Rating	Max. A	Pulse	Max. Load
Rating: CO ₂	1600W	580A	-	25KW
	1200W	550A	-	23KW
	1000W	520A	-	21KW
Rating: Mixed Gas M21	1600W	560A	400A	23KW
	1200W	530A	360A	21.5KW
	1000W	510A	350A	20KW
Duty Cycle		100%	100%	
Wire Size	Filler Wires	Fe, Fe-MC / FC		0.9-2.0mm
	Filler Wires	Ss, Ss-MC / FC		0.9-1.6mm
	Filler Wires	Al		1.0-2.0mm
Minimum Liquid Flow Rate		1.5 l/min		Important: Please note minimum inlet pressure and flow rate. Low pressure will affect torch performance
Minimum Liquid Inlet Pressure		2.5 Bar		
Maximum Liquid Inlet Pressure		5.0 Bar		
Maximum Liquid Inlet Temperature		50°C		
Operating Temperature Range		-10...+40°C		



M1 Air-Cooled Mig Welding Torch

Ratings:	180A CO ₂ , 150A mixed gas M21, EN60974-7 @ 60% duty cycle. 0.6mm-1.0mm wires
----------	---

The Arc M1 is the same size as an MB15 yet 20% lighter

ARC M INDUSTRIAL MIG TORCH PACKAGES

M1 Torches are supplied with a Euro termination as standard and are supplied 'ready to weld' with all wear parts fitted.

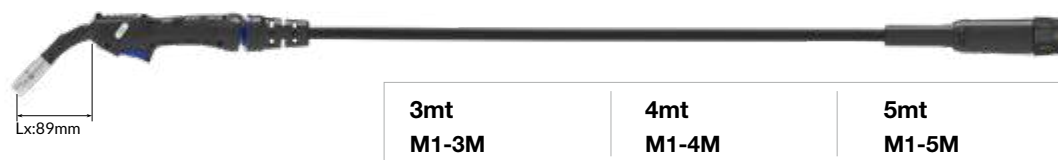

Wear Parts

A Nozzles

Part Number	Description	Bore	Wall	Material
•AM1CN	Conical Nozzle Assembly	12mm	1.0mm	Copper
AM1TN	Tapered Nozzle Assembly	10.6mm	1.0mm	Copper

B Contact Tips

Part Number	Description	Size (mm)	Wire Size (mm-inch)	Material
AM1CT06	Contact Tip	M6*25.0	0.6 - 0.023	Copper
•AM1CT08	Contact Tip	M6*25.0	0.8 - 0.030	Copper
AM1CT09	Contact Tip	M6*25.0	0.9 - 0.035	Copper
AM1CT10	Contact Tip	M6*25.0	1.0 - 0.040	Copper
AM1CT12	Contact Tip	M6*25.0	1.2 - 0.045	Copper
AM1CT08A	Contact Tip	M6*25.0	0.8 - 0.030	Copper
AM1CT10A	Contact Tip	M6*25.0	1.0 - 0.040	Copper
AM1CT12A	Contact Tip	M6*25.0	1.2 - 0.045	Copper

C Tip Adaptors

Part Number	Description	Material
•AM1TA	Tip Adaptor	Brass

•Denotes torch package standard wear part set-up

D Liners

Part Number	Description	Wire Size
•AM1535-30	Steel Liner x 3mt	0.6-0.9mm
•AM1535-40	Steel Liner x 4mt	0.6-0.9mm
•AM1535-50	Steel Liner x 5mt	0.6-0.9mm

For alternate liner options please refer to page 40

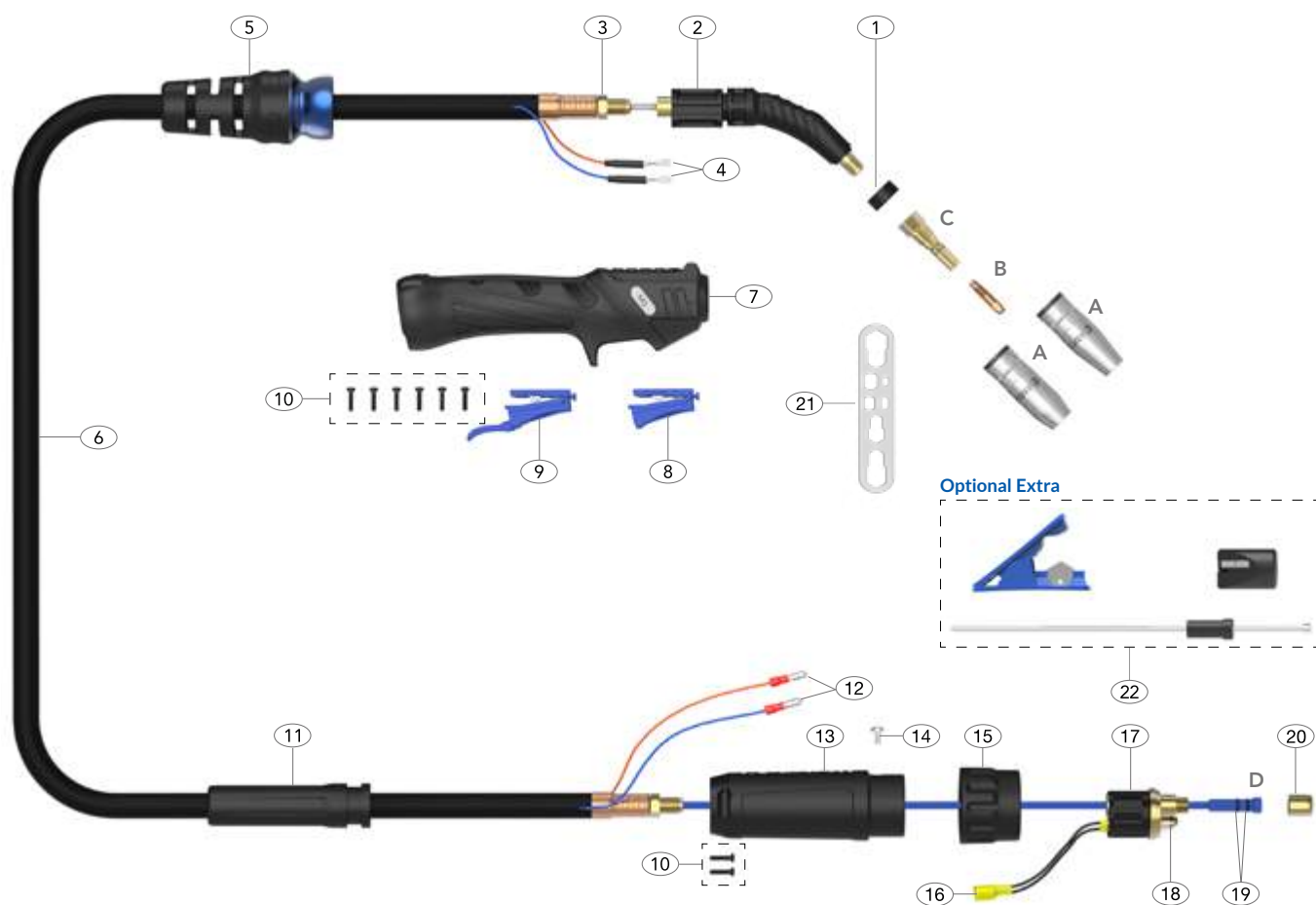

Spare Parts

Part Number	Description
1 AM1AP	Neck Insulator
2 AM1001	Swan Neck Assembly
3 AM1505	Lock Nut
4 AM1521	Cable Terminal
5 AM1514	Handle Cable Support c/w Ball Joint
6 AM1517-30	Ultraflex Cable Assembly x 3mt
AM1517-40	Ultraflex Cable Assembly x 4mt
AM1517-50	Ultraflex Cable Assembly x 5mt
7 AM2514	Handle Kit
8 AM2516	Microswitch Standard Trigger
9 AM2516L	Microswitch Extended Trigger
10 AMSP1-1	Screw Pack
11 AM2841	Cable Support
12 AM1522	Cable Terminal Male
13 AM2578/S	Gun Plug Housing
14 AML1541	Gun Plug Screw
15 AMC1519/S	Gun Plug Nut
16 AM1523	Gun Plug Terminal Female

Part Number	Description
17 AM1528	Hybrid Gun Plug Body c/w Spring Pins
18 AM1524	Gun Plug 'O' Ring
19 AMLOR	Liner 'O' Ring
20 AM1826	Liner Retaining Nut
21 AMWS	Wear Parts Spanner
Optional Extra	
22 AMCLST-KITS	Combi-Liner Set-up kit

Welding with Soft Wires

For welding with Aluminum wires use a Combi-liner (page 40). Optimum installation is achieved when using the Combi-liner set-up kit.



Liner Set- up Guide

Always follow the correct liner installation procedure

M18 Air-Cooled Mig Welding Torch

Ratings:	210A CO ₂ , 180A mixed gas M21, EN60974-7 @ 60% duty cycle. 0.6mm-1.0mm wires
----------	---

The same footprint as an M1 with improved power rating.

Ideal for 0.8mm hard wires and semi-industrial environments.

ARC M INDUSTRIAL MIG TORCH PACKAGES

M18 Torches are supplied with a Euro termination as standard and are supplied 'ready to weld' with all wear parts fitted.

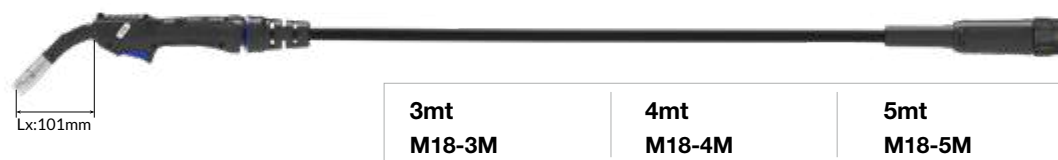

Wear Parts

A Nozzles

Part Number	Description	Bore	Wall	Material
•AM18CN	Conical Nozzle Assembly	14mm	1.5mm	Copper
AM18TN	Tapered Nozzle Assembly	12mm	1.5mm	Copper

B Contact Tips

Part Number	Description	Size (mm)	Wire Size (mm-inch)	Material
AM1CT06	Contact Tip	M6*25.0	0.6 - 0.023	Copper
•AM1CT08	Contact Tip	M6*25.0	0.8 - 0.030	Copper
AM1CT09	Contact Tip	M6*25.0	0.9 - 0.035	Copper
AM1CT10	Contact Tip	M6*25.0	1.0 - 0.040	Copper
AM1CT12	Contact Tip	M6*25.0	1.2 - 0.045	Copper
AM1CT08A	Contact Tip	M6*25.0	0.8 - 0.030	Copper
AM1CT10A	Contact Tip	M6*25.0	1.0 - 0.040	Copper
AM1CT12A	Contact Tip	M6*25.0	1.2 - 0.045	Copper

C Tip Adaptors

Part Number	Description	Material
•AM18TA	Tip Adaptor	Brass

• Denotes torch package standard wear part set-up

D Liners

Part Number	Description	Wire Size
•AM1535-30	Steel Liner x 3mt	0.6-0.9mm
•AM1535-40	Steel Liner x 4mt	0.6-0.9mm
•AM1535-50	Steel Liner x 5mt	0.6-0.9mm

For alternate liner options please refer to page 40

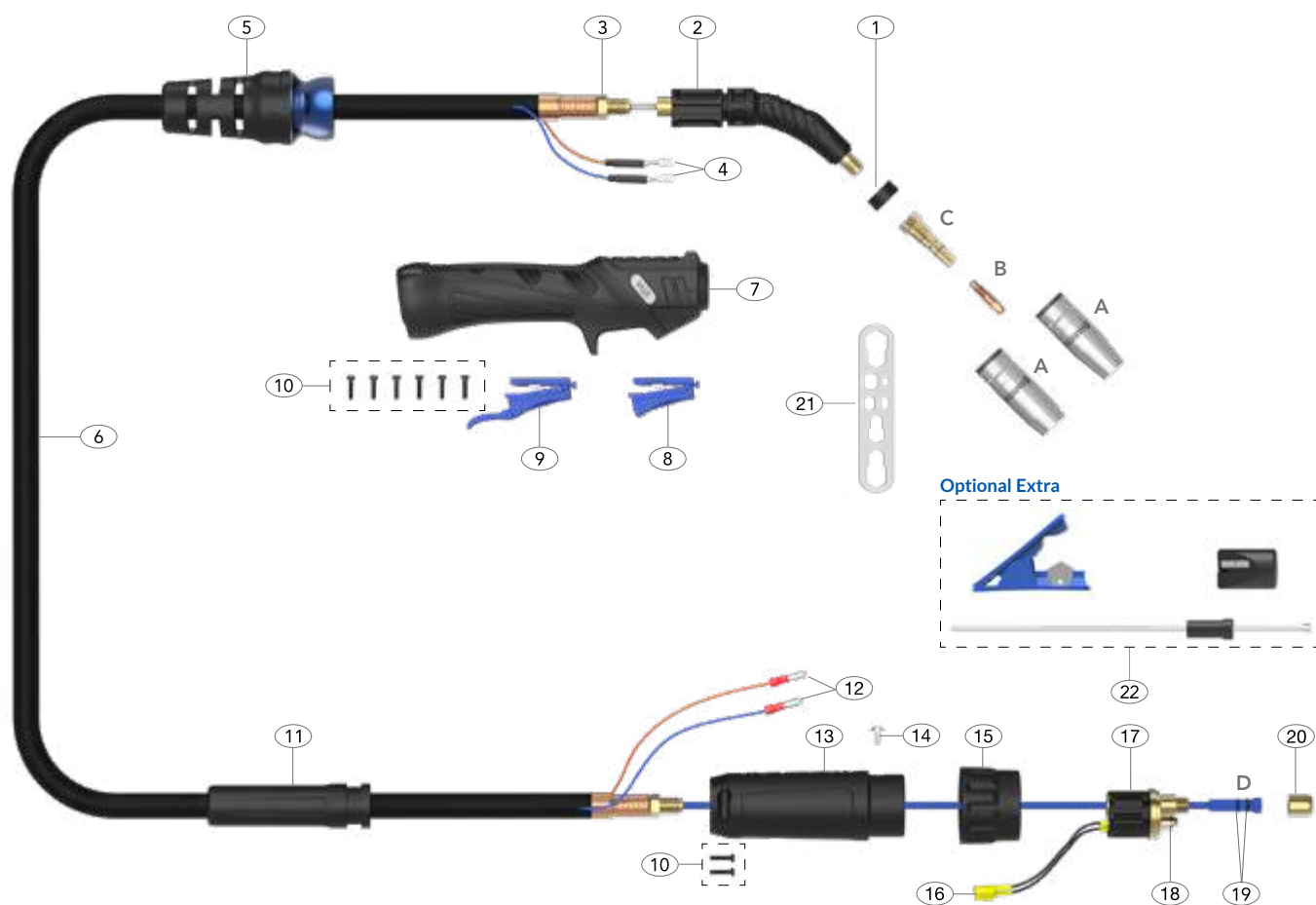

Spare Parts

Part Number	Description
1 AM18AP	Neck Insulator
2 AM18001	Swan Neck Assembly
3 AM1505	Lock Nut
4 AM1521	Cable Terminal
5 AM1514	Handle Cable Support c/w Ball Joint
6 AM1817-30	Ultraflex Cable Assembly x 3mt
AM1817-40	Ultraflex Cable Assembly x 4mt
AM1817-50	Ultraflex Cable Assembly x 5mt
7 AM2514	Handle Kit
8 AM2516	Microswitch Standard Trigger
9 AM2516L	Microswitch Extended Trigger
10 AMSP1-1	Screw Pack
11 AM2841	Cable Support
12 AM1522	Cable Terminal Male
13 AM2578/S	Gun Plug Housing
14 AML1541	Gun Plug Screw
15 AMC1519/S	Gun Plug Nut
16 AM1523	Gun Plug Terminal Female

Part Number	Description
17 AM1528	Hybrid Gun Plug Body c/w Spring Pins
18 AM1524	Gun Plug 'O' Ring
19 AMLOR	Liner 'O' Ring
20 AM1826	Liner Retaining Nut
21 AMWS	Wear Parts Spanner
Optional Extra	
22 AMCLST-KITS	Combi-Liner Set-up kit

Welding with Soft Wires

For welding with Aluminum wires use a Combi-liner (page 40). Optimum installation is achieved when using the Combi-liner set-up kit.



Liner Set- up Guide

Always follow the correct liner installation procedure

M2 Air-Cooled Mig Welding Torch

Ratings:	230A CO ₂ , 200A mixed gas M21, 110A pulse. EN60974-7 @ 60% duty cycle. 0.8mm-1.2mm wires
----------	---

The Arc M2 is the same size as an MB25 yet 20% lighter.
Ideal for 0.8-1.0mm hard wires and industrial environments.



ARC M INDUSTRIAL MIG TORCH PACKAGES

M2 Torches are supplied with a Euro termination as standard and are supplied 'ready to weld' with all wear parts fitted.



Wear Parts

A Nozzles

Part Number	Description	Bore	Wall	Material
•AM2CN	Conical Nozzle Assembly	15mm	1.9mm	Copper
AM2TN	Tapered Nozzle Assembly	12mm	1.9mm	Copper

B Contact Tips

Part Number	Description	Size (mm)	Wire Size (mm-inch)	Material
AM2CT08	Contact Tip	M8*29.5	0.8 - 0.030	Copper
AM2CT09	Contact Tip	M8*29.5	0.9 - 0.035	Copper
•AM2CT10	Contact Tip	M8*29.5	1.0 - 0.040	Copper
AM2CT12	Contact Tip	M8*29.5	1.2 - 0.045	Copper
AM2CT08A	Contact Tip	M8*29.5	0.8 - 0.030	Copper
AM2CT10A	Contact Tip	M8*29.5	1.0 - 0.040	Copper
AM2CT12A	Contact Tip	M8*29.5	1.2 - 0.045	Copper

C Tip Adaptors

Part Number	Description	Material
•AM2TA	Tip Adaptor	Brass

•Denotes torch package standard wear part set-up

D Liners

Part Number	Description	Wire Size
•AM2524-30	Steel Liner x 3mt	1.0-1.2mm
•AM2524-40	Steel Liner x 4mt	1.0-1.2mm
•AM2524-50	Steel Liner x 5mt	1.0-1.2mm

For alternate liner options please refer to page 40

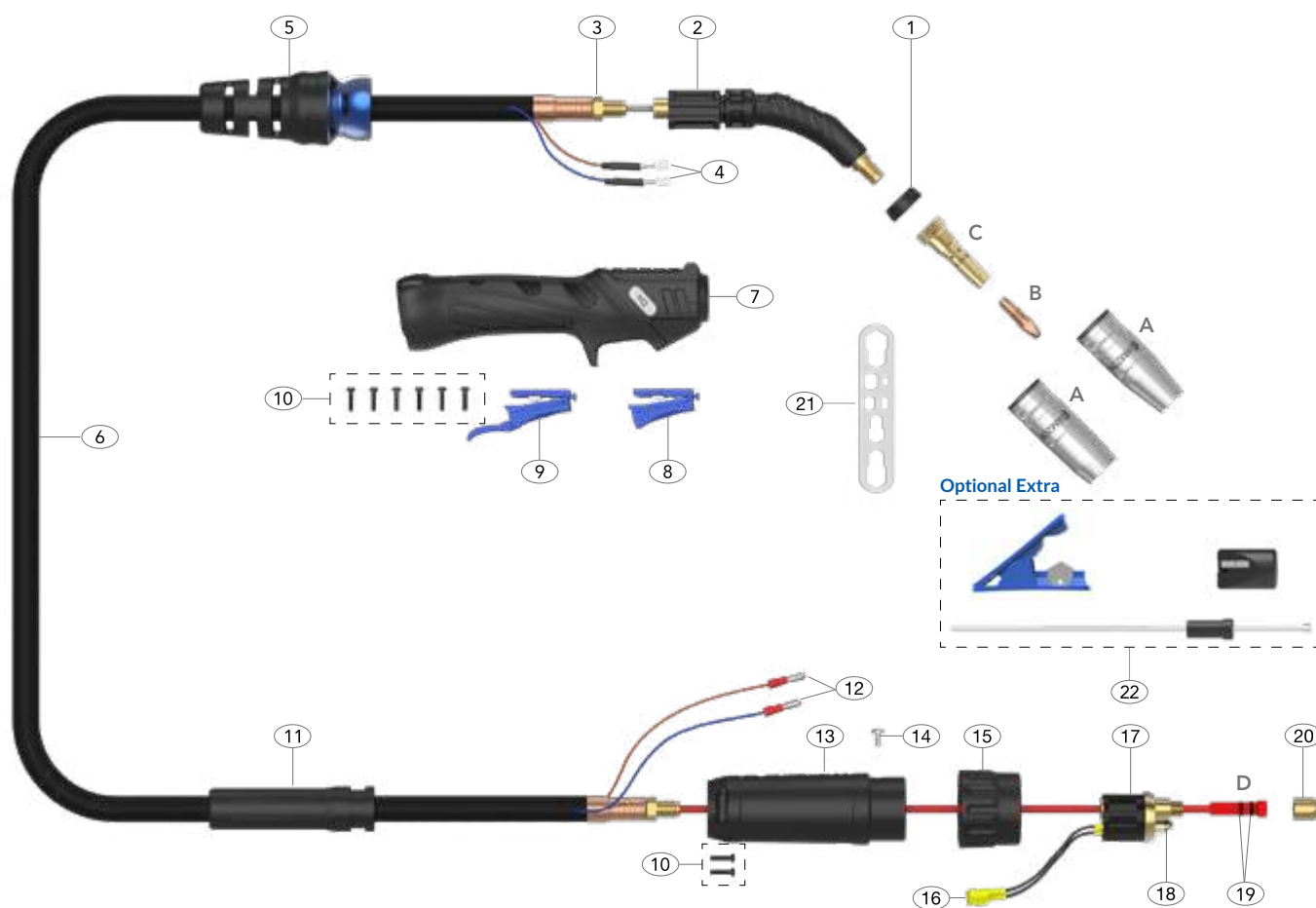

Spare Parts

Part Number	Description
1 AM2AP	Neck Insulator
2 AM2001	Swan Neck Assembly
3 AM1505	Lock Nut
4 AM1521	Cable Terminal
5 AM1514	Handle Cable Support c/w Ball Joint
6 AM2503-30	Ultraflex Cable Assembly x 3mt
AM2503-40	Ultraflex Cable Assembly x 4mt
AM2503-50	Ultraflex Cable Assembly x 5mt
7 AM2514	Handle Kit
8 AM2516	Microswitch Standard Trigger
9 AM2516L	Microswitch Extended Trigger
10 AMSP1-1	Screw Pack
11 AM2841	Cable Support
12 AM1522	Cable Terminal Male
13 AM2578/S	Gun Plug Housing
14 AML1541	Gun Plug Screw
15 AMC1519/S	Gun Plug Nut
16 AM1523	Gun Plug Terminal Female

Part Number	Description
17 AM1528	Hybrid Gun Plug Body c/w Spring Pins
18 AM1524	Gun Plug 'O' Ring
19 AMLOR	Liner 'O' Ring
20 AM1826	Liner Retaining Nut
21 AMWS	Wear Parts Spanner
Optional Extra	
22 AMCLST-KITS	Combi-Liner Set-up kit

Welding with Soft Wires

For welding with Aluminum wires use a Combi-liner (page 40). Optimum installation is achieved when using the Combi-liner set-up kit.



Liner Set- up Guide

Always follow the correct liner installation procedure

M22 Air-Cooled Mig Welding Torch

Ratings:	250A CO ₂ , 220A mixed gas M21, 120A pulse. EN60974-7 @ 60% duty cycle. 0.8mm-1.2mm wires
----------	---

The Arc M22 is the same size as an MB24 yet 20% lighter.

A great all-round Industrial torch for high duty 200 Amp solid wires and low duty Pulse Mig Aluminium applications.

ARC M INDUSTRIAL MIG TORCH PACKAGES

M22 Torches are supplied with a Euro termination as standard and are supplied 'ready to weld' with all wear parts fitted.

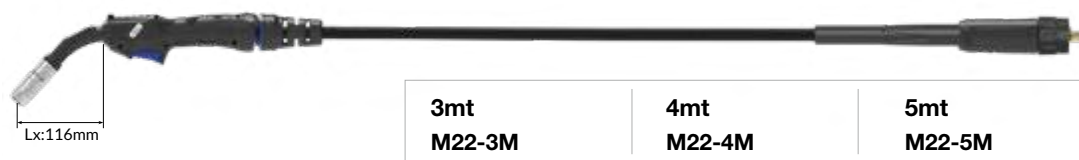

Wear Parts

A Nozzles

Part Number	Description	Bore	Wall	Material
•AM22CN	Conical Nozzle Assembly	16mm	1.75mm	Copper
AM22CNHD	Conical Nozzle HD Assembly	16mm	2.00mm	Copper
AM22TN	Tapered Nozzle Assembly	14mm	1.75mm	Copper

D Liners

Part Number	Description	Wire Size
•AM2524-30	Steel Liner x 3mt	1.0-1.2mm
•AM2524-40	Steel Liner x 4mt	1.0-1.2mm
•AM2524-50	Steel Liner x 5mt	1.0-1.2mm

For alternate liner options please refer to page 40

B Contact Tips

Part Number	Description	Size (mm)	Wire Size (mm-inch)	Material
AM2CT08	Contact Tip	M8*29.5	0.8 - 0.030	Copper
AM2CT09	Contact Tip	M8*29.5	0.9 - 0.035	Copper
•AM2CT10	Contact Tip	M8*29.5	1.0 - 0.040	Copper
AM2CT12	Contact Tip	M8*29.5	1.2 - 0.045	Copper
AM2CT08A	Contact Tip	M8*29.5	0.8 - 0.030	Copper
AM2CT10A	Contact Tip	M8*29.5	1.0 - 0.040	Copper
AM2CT12A	Contact Tip	M8*29.5	1.2 - 0.045	Copper

C Tip Adaptors

Part Number	Description	Material
•AM22TA	Tip Adaptor	Brass

•Denotes torch package standard wear part set-up

Arc Conical HD Nozzle

Ideal for High Amperage and Pulse Welding

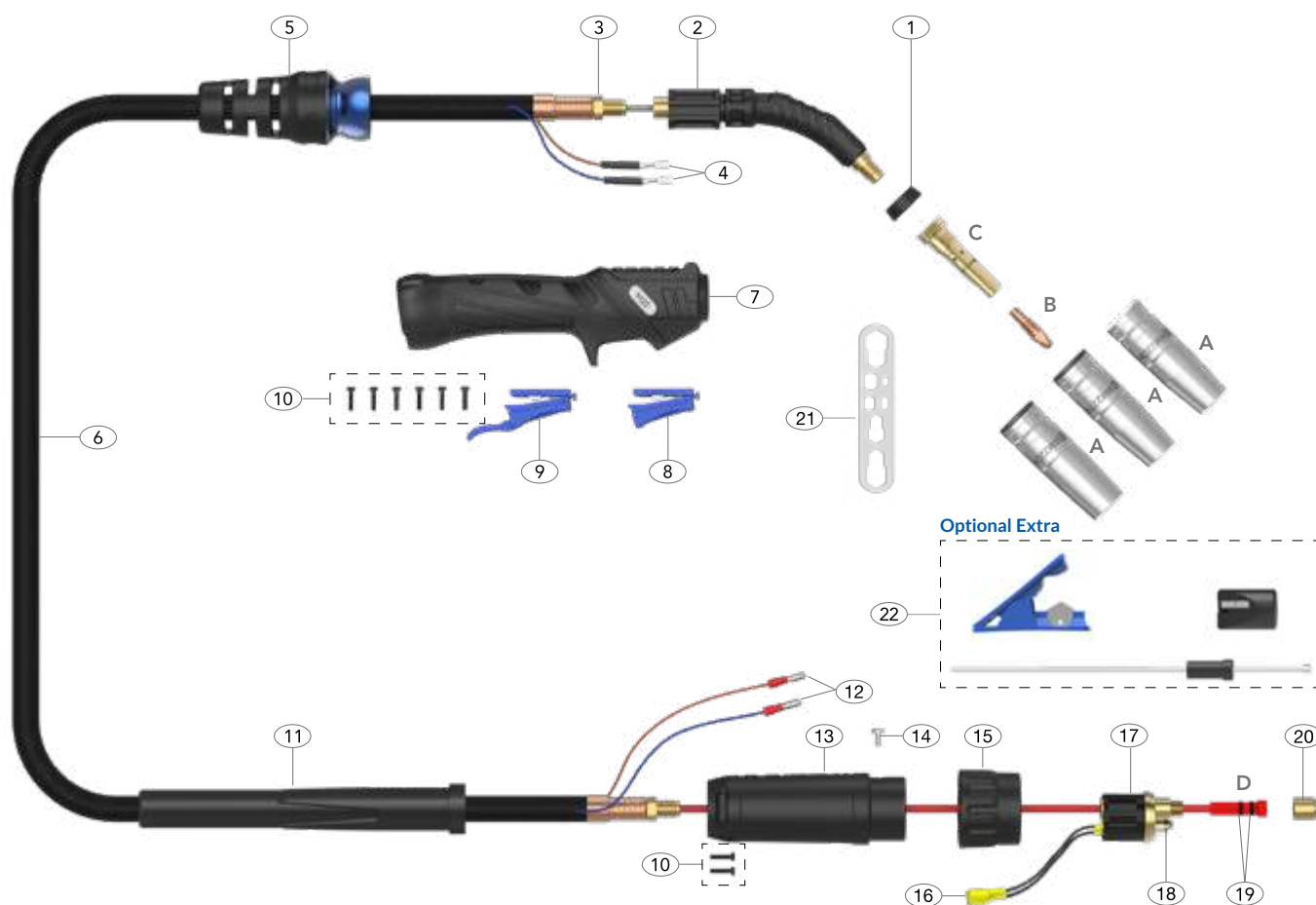

Spare Parts

Part Number	Description
1 AM2AP	Neck Insulator
2 AM22001	Swan Neck Assembly
3 AM1505	Lock Nut
4 AM1521	Cable Terminal
5 AM1514	Handle Cable Support c/w Ball Joint
6 AM2603-30	Ultraflex Cable Assembly x 3mt
AM2603-40	Ultraflex Cable Assembly x 4mt
AM2603-50	Ultraflex Cable Assembly x 5mt
7 AM2514	Handle Kit
8 AM2516	Microswitch Standard Trigger
9 AM2516L	Microswitch Extended Trigger
10 AMSP1-1	Screw Pack
11 AMPA3541	Cable Support
12 AM1522	Cable Terminal Male
13 AM2578/L	Gun Plug Housing
14 AML1541	Gun Plug Screw
15 AMC1519/S	Gun Plug Nut
16 AM1523	Gun Plug Terminal Female

Part Number	Description
17 AM1528	Hybrid Gun Plug Body c/w Spring Pins
18 AM1524	Gun Plug 'O' Ring
19 AMLOR	Liner 'O' Ring
20 AM1826	Liner Retaining Nut
21 AMWS	Wear Parts Spanner
Optional Extra	
22 AMCLST-KITS	Combi-Liner Set-up kit

Welding with Soft Wires

For welding with Aluminum wires use a Combi-liner (page 40). Optimum installation is achieved when using the Combi-liner set-up kit.



Liner Set- up Guide

Always follow the correct liner installation procedure

M2M Air-Cooled Mig Welding Torch - Multijust

Ratings:	230A CO ₂ , 200A mixed gas M21, 110A pulse. EN60974-7 @ 60% duty cycle. 0.8mm-1.2mm wires
----------	---

The Arc M2M is ideal for 0.8-1.0mm hard wires and industrial environments. Fitted with a longer neck with 360° rotation, perfect for multiple positions in difficult to reach areas.

ARC M INDUSTRIAL MIG TORCH PACKAGES - MULTIJUST

M2M Multijust Torches are supplied with a Euro termination as standard and are supplied 'ready to weld' with all wear parts fitted.



Wear Parts

A Nozzles

Part Number	Description	Bore	Wall	Material
•AM2CN	Conical Nozzle Assembly	15mm	1.9mm	Copper
AM2TN	Tapered Nozzle Assembly	12mm	1.9mm	Copper

B Contact Tips

Part Number	Description	Size (mm)	Wire Size (mm-inch)	Material
AM2CT08	Contact Tip	M8*29.5	0.8 - 0.030	Copper
AM2CT09	Contact Tip	M8*29.5	0.9 - 0.035	Copper
•AM2CT10	Contact Tip	M8*29.5	1.0 - 0.040	Copper
AM2CT12	Contact Tip	M8*29.5	1.2 - 0.045	Copper
AM2CT08A	Contact Tip	M8*29.5	0.8 - 0.030	Copper
AM2CT10A	Contact Tip	M8*29.5	1.0 - 0.040	Copper
AM2CT12A	Contact Tip	M8*29.5	1.2 - 0.045	Copper

C Tip Adaptors

Part Number	Description	Material
•AM2TA	Tip Adaptor	Brass

•Denotes torch package standard wear part set-up

D Liners

Part Number	Description	Wire Size
•AM2524-30	Steel Liner x 3mt	1.0-1.2mm
•AM2524-40	Steel Liner x 4mt	1.0-1.2mm
•AM2524-50	Steel Liner x 5mt	1.0-1.2mm

For alternate liner options please refer to page 40

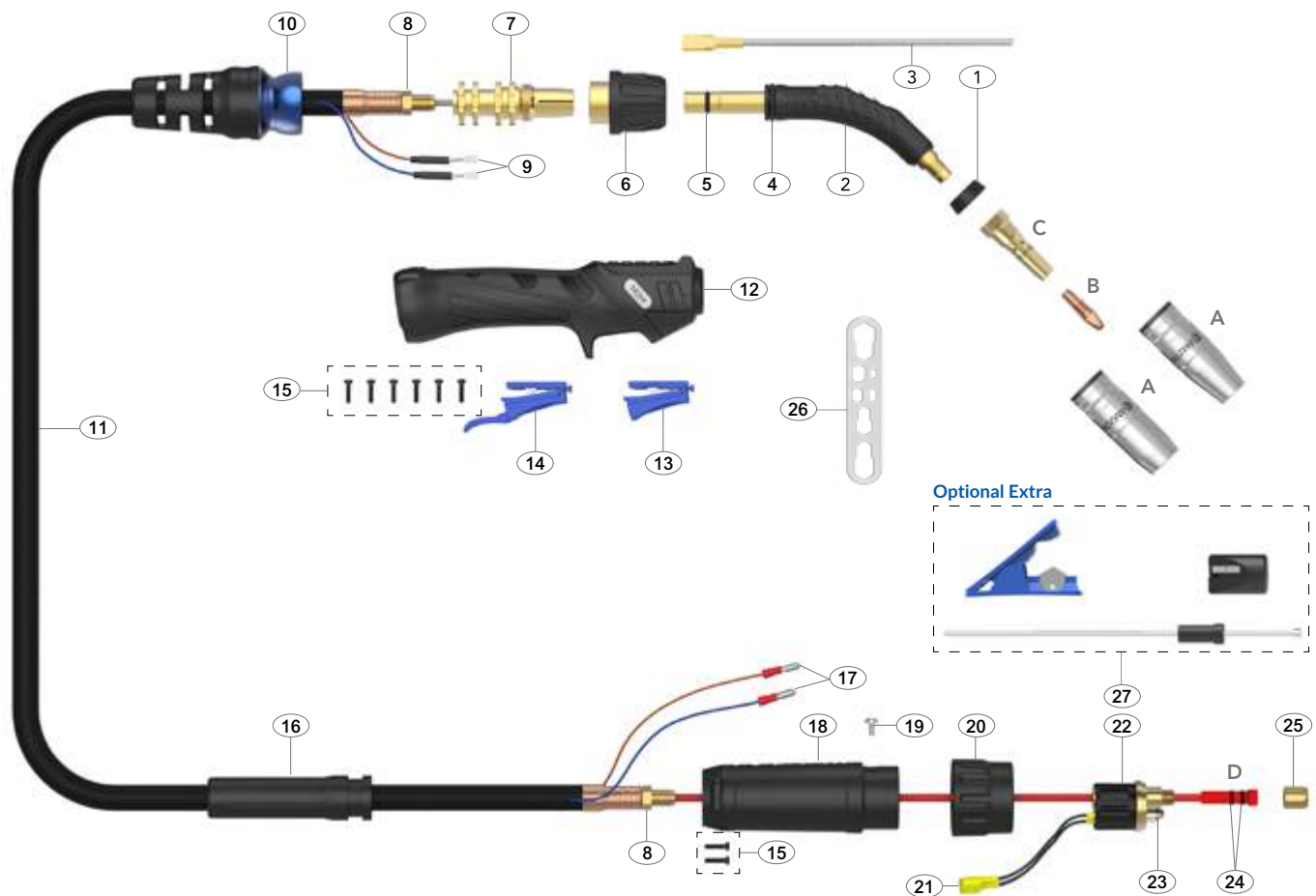

Spare Parts

Part Number	Description
1 AM2AP	Neck Insulator
2 AM2001M	Swan Neck Assembly - Multijust
3 AM2MJL	Neck Jump Liner 0.8-1.2mm - Hard Wire
4 AM-MJ1509	Neck 'O' Ring(Ø14xØ2.5)
5 AM-MJ1508	Neck 'O' Ring(Ø8.5xØ1.5)
6 AM1516M	Neck Nut - Multijust
7 AM1515M	Socket Connection
8 AM1505	Lock Nut
9 AM1521	Cable Terminal
10 AM1514	Handle Cable Support c/w Ball Joint
11 AM2503-30	Ultraflex Cable Assembly x 3mt
AM2503-40	Ultraflex Cable Assembly x 4mt
AM2503-50	Ultraflex Cable Assembly x 5mt
12 AM2514	Handle Kit
13 AM2516	Microswitch Standard Trigger
14 AM2516L	Microswitch Extended Trigger
15 AMSP1-1	Screw Pack
16 AM2841	Cable Support
17 AM1522	Cable Terminal Male
18 AM2578/S	Gun Plug Housing
19 AML1541	Gun Plug Screw
20 AMC1519/S	Gun Plug Nut
21 AM1523	Gun Plug Terminal Female

Part Number	Description
22 AM1528	Hybrid Gun Plug Body c/w Spring Pins
23 AM1524	Gun Plug 'O' Ring
24 AMLOR	Liner 'O' Ring
25 AM1826	Liner Retaining Nut
26 AMWS	Wear Parts Spanner
Optional Extra	
27 AMCLST-KITS	Combi-Liner Set-up kit

Welding with Soft Wires

For welding with Aluminum wires use a Combi-liner (page 40). Optimum installation is achieved when using the Combi-liner set-up kit.

M22M Air-Cooled Mig Welding Torch - Multijust

Ratings:	250A CO ₂ , 220A mixed gas M21, 120A pulse. EN60974-7 @ 60% duty cycle. 0.8mm-1.2mm wires
----------	---

A great all-round Industrial torch for high duty 200 Amp solid wires and low duty Pulse Mig Aluminium applications.
Fitted with a longer neck with 360° rotation, perfect for multiple positions in difficult to reach areas.

ARC M INDUSTRIAL MIG TORCH PACKAGES - MULTIJUST

M22M Multijust Torches are supplied with a Euro termination as standard and are supplied 'ready to weld' with all wear parts fitted.

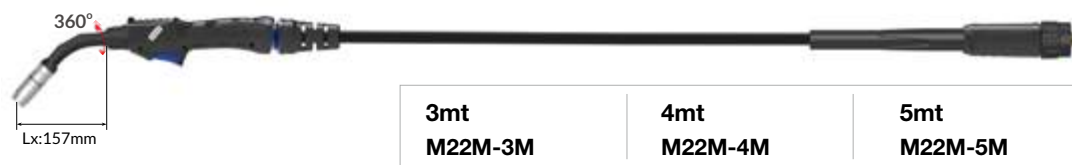

Wear Parts

A Nozzles

Part Number	Description	Bore	Wall	Material
•AM22CN	Conical Nozzle Assembly	16mm	1.75mm	Copper
AM22CNHD	Conical Nozzle HD Assembly	16mm	2.00mm	Copper
AM22TN	Tapered Nozzle Assembly	14mm	1.75mm	Copper

D Liners

Part Number	Description	Wire Size
•AM2524-30	Steel Liner x 3mt	1.0-1.2mm
•AM2524-40	Steel Liner x 4mt	1.0-1.2mm
•AM2524-50	Steel Liner x 5mt	1.0-1.2mm

For alternate liner options please refer to page 40

B Contact Tips

Part Number	Description	Size (mm)	Wire Size (mm-inch)	Material
AM2CT08	Contact Tip	M8*29.5	0.8 - 0.030	Copper
AM2CT09	Contact Tip	M8*29.5	0.9 - 0.035	Copper
•AM2CT10	Contact Tip	M8*29.5	1.0 - 0.040	Copper
AM2CT12	Contact Tip	M8*29.5	1.2 - 0.045	Copper
AM2CT08A	Contact Tip	M8*29.5	0.8 - 0.030	Copper
AM2CT10A	Contact Tip	M8*29.5	1.0 - 0.040	Copper
AM2CT12A	Contact Tip	M8*29.5	1.2 - 0.045	Copper

C Tip Adaptors

Part Number	Description	Material
•AM22TA	Tip Adaptor	Brass

•Denotes torch package standard wear part set-up

Arc Conical HD Nozzle

Recommended for High Amperage and Pulse Welding

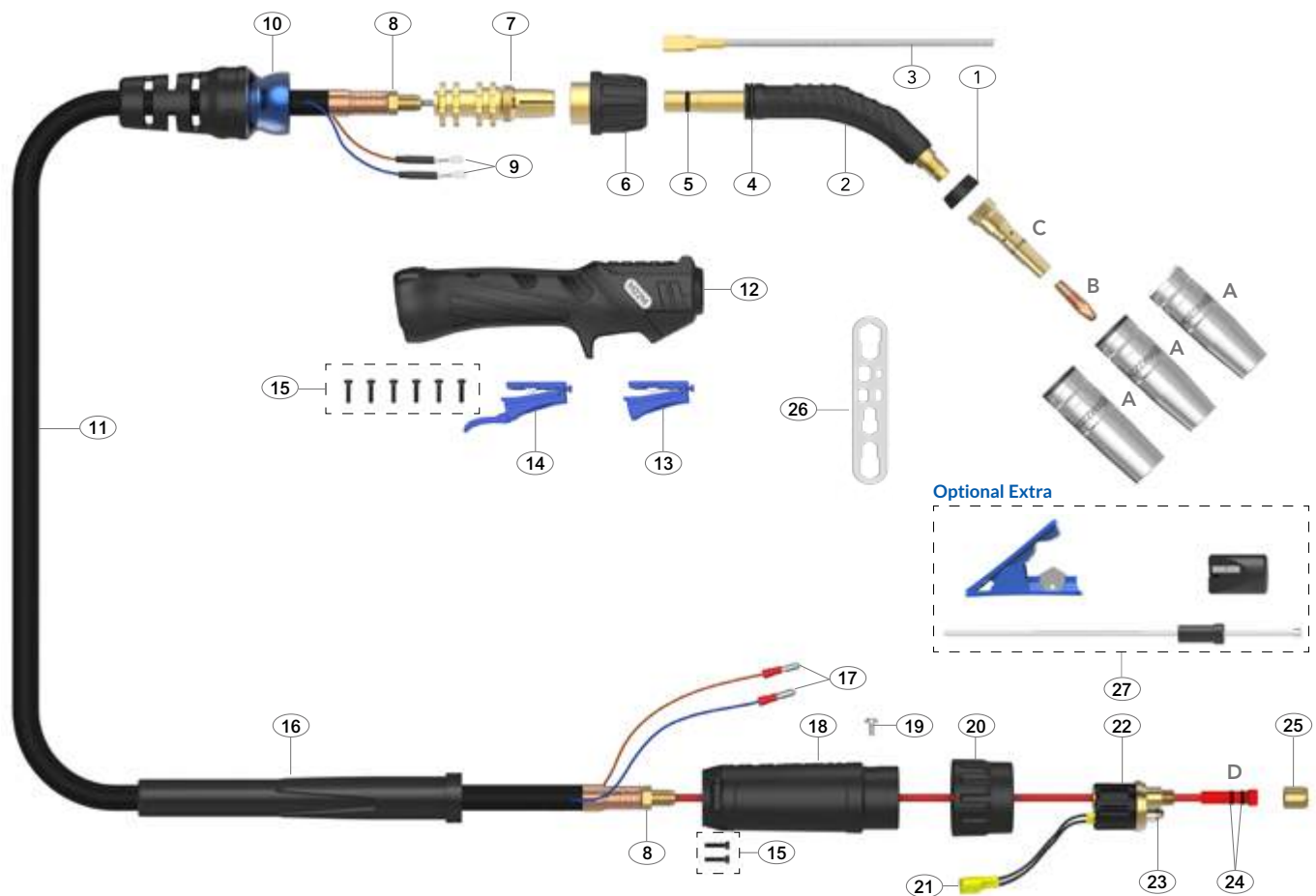

Spare Parts

Part Number	Description
1 AM2AP	Neck Insulator
2 AM22001M	Swan Neck Assembly - Multijust
3 AM22MJL	Neck Jump Liner 0.8-1.2mm - Hard Wire
4 AM-MJ1509	Neck 'O' Ring(Ø14xØ2.5)
5 AM-MJ1508	Neck 'O' Ring(Ø8.5xØ1.5)
6 AM1516M	Neck Nut - Multijust
7 AM1515M	Socket Connection
8 AM1505	Lock Nut
9 AM1521	Cable Terminal
10 AM1514	Handle Cable Support c/w Ball Joint
11 AM2603-30	Ultraflex Cable Assembly x 3mt
AM2603-40	Ultraflex Cable Assembly x 4mt
AM2603-50	Ultraflex Cable Assembly x 5mt
12 AM2514	Handle Kit
13 AM2516	Microswitch Standard Trigger
14 AM2516L	Microswitch Extended Trigger
15 AMSP1-1	Screw Pack
16 AMPA3541	Cable Support
17 AM1522	Cable Terminal Male
18 AM2578/L	Gun Plug Housing
19 AML1541	Gun Plug Screw
20 AMC1519/S	Gun Plug Nut
21 AM1523	Gun Plug Terminal Female

Part Number	Description
22 AM1528	Hybrid Gun Plug Body c/w Spring Pins
23 AM1524	Gun Plug 'O' Ring
24 AMLOR	Liner 'O' Ring
25 AM1826	Liner Retaining Nut
26 AMWS	Wear Parts Spanner
Optional Extra	
27 AMCLST-KITS	Combi-Liner Set-up kit

Welding with Soft Wires

For welding with Aluminum wires use a Combi-liner (page 40). Optimum installation is achieved when using the Combi-liner set-up kit.

M3 Air-Cooled Mig Welding Torch

Ratings:	300A CO ₂ , 270A mixed gas M21, EN60974-7 @ 60% duty cycle. 0.9mm-1.2mm wires
----------	---

The Arc M3 is a true 300 Amp Torch which outperforms all Binzel® MB36 derivatives and is ideal for 1.2mm production work.

ARC M HIGH PERFORMANCE MIG TORCH PACKAGES

M3 Torches are supplied with a Euro termination as standard and are supplied 'ready to weld' with all wear parts fitted.

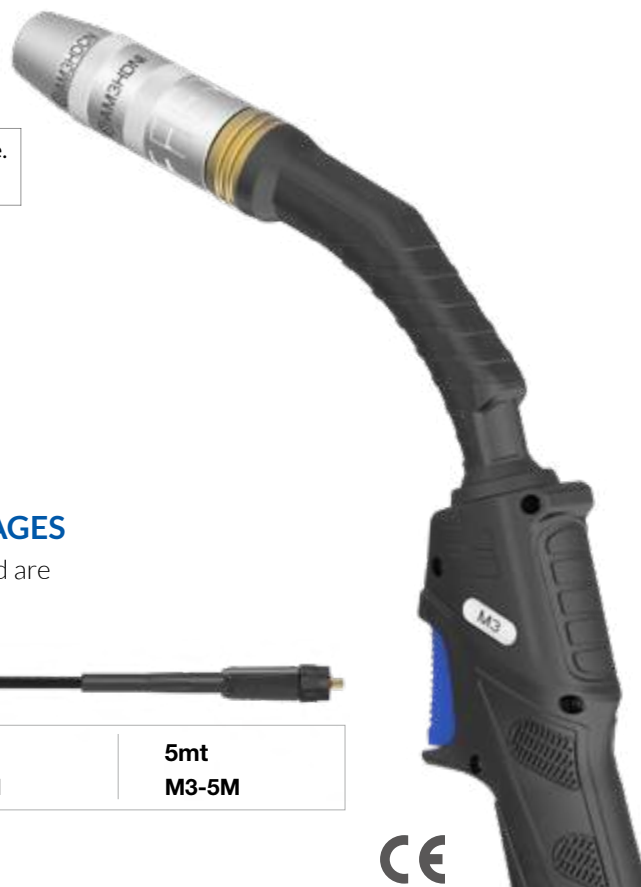
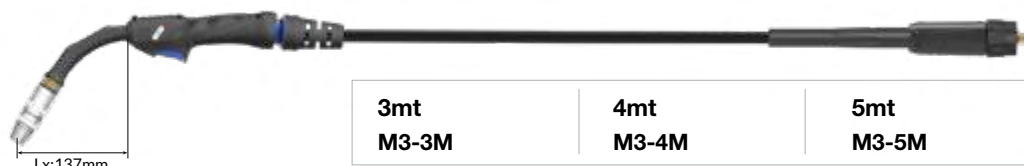

Wear Parts

Nozzles - 2 Piece

	Part Number	Description	Bore	Wall	Material
A	AM3HDTN	Tapered Nozzle (Part 2)	12mm	3mm	Copper
	•AM3HDCN	Conical Nozzle (Part 2)	14mm	3mm	Copper
	AM3HDCYN	Cylindrical Nozzle (Part 2)	19mm	3mm	Copper
A1	•AM3HDNI	Nozzle Insulator(Part 1)			Copper

Nozzles - Single Piece

A2	AM3TN	Tapered Nozzle / Insulator Assy	12mm	2.25mm	Copper
	AM3CN	Conical Nozzle / Insulator Assy	14mm	2.25mm	Copper
	AM3CYN	Cylindrical Nozzle / Insulator Assy	19mm	2.25mm	Copper

B Contact Tips

	Part Number	Description	Size (mm)	Wire Size (mm-inch)	Material
Standard Series					
	AM5CT09	Contact Tip	M8*29.5	0.9-0.035	CuCrZr
	AM5CT10	Contact Tip	M8*29.5	1.0-0.040	CuCrZr
	•AM5CT12	Contact Tip	M8*29.5	1.2-0.045	CuCrZr
A Series					
	AM5CT10A	Contact Tip	M8*29.5	1.0-0.040	CuCrZr
	AM5CT12A	Contact Tip	M8*29.5	1.2-0.045	CuCrZr
	AM2CT10A	Contact Tip	M8*29.5	1.0-0.040	Copper
	AM2CT12A	Contact Tip	M8*29.5	1.2-0.045	Copper

C Tip Adaptors

Part Number	Description	Material
•AM3TAB	Tip Adaptor	Brass
AM3TAC	Tip Adaptor High Performance	CuCrZr

D Liners

Part Number	Description	Wire Size
•AM2524-30	Steel Liner x 3mt	1.0-1.2mm
•AM2524-40	Steel Liner x 4mt	1.0-1.2mm
•AM2524-50	Steel Liner x 5mt	1.0-1.2mm
AM1535-30	Steel Liner x 3mt	0.6-0.9mm
AM1535-40	Steel Liner x 4mt	0.6-0.9mm
AM1535-50	Steel Liner x 5mt	0.6-0.9mm

• Denotes torch package standard wear part set-up

SuperSoft -20 Premium Power Cables
Perfect for extreme subzero working conditions

® All Trademarks are the property of their respective owners and usage is for cross reference only

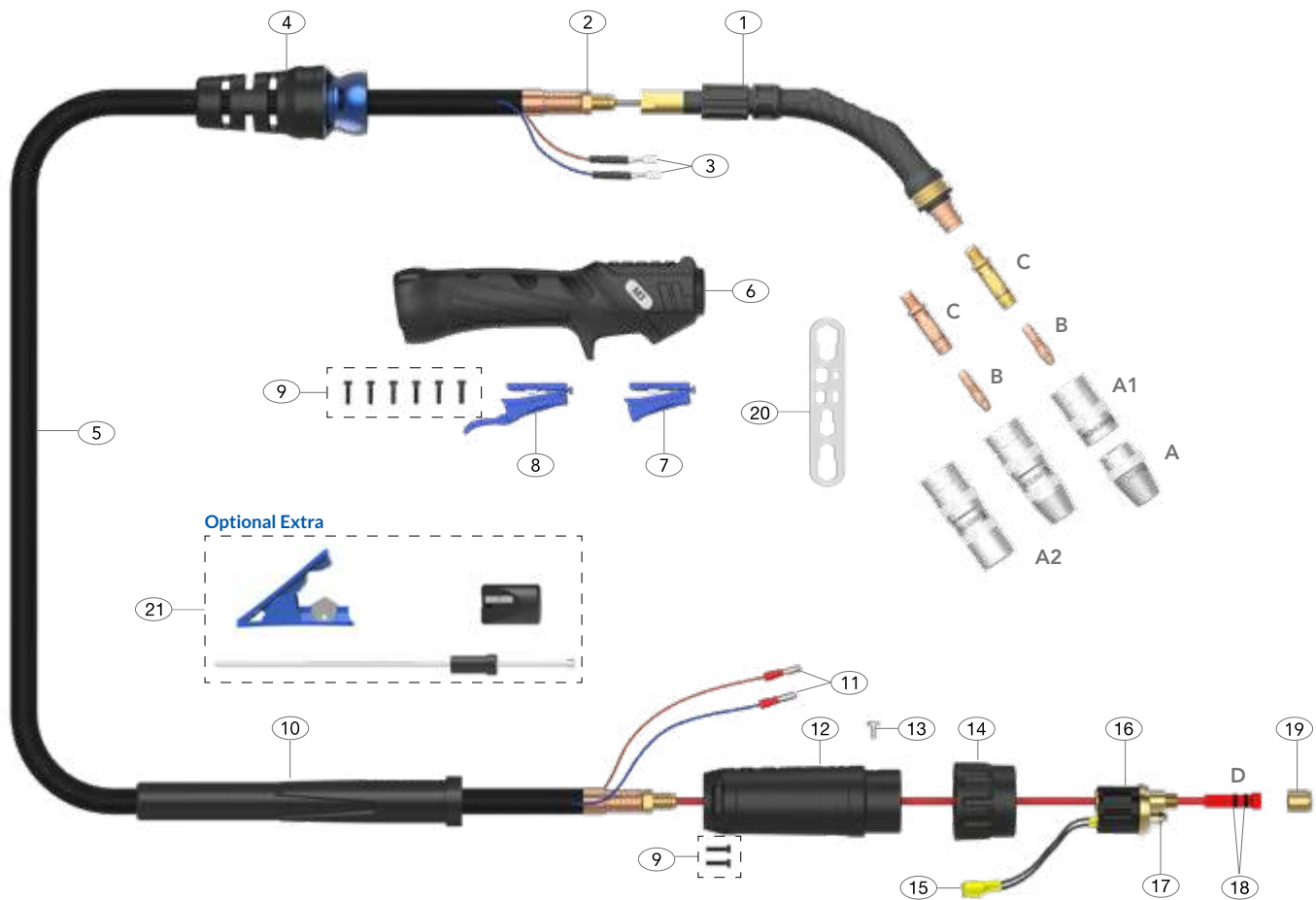

Spare Parts

Part Number	Description
1 AM3001	Swan Neck Assembly
2 AM1505	Lock Nut
3 AM1521	Cable Terminal
4 AM1514	Handle Cable Support c/w Ball Joint
5 AM3003CW-30	Power Cable Assembly x 3mt
AM3003CW-40	Power Cable Assembly x 4mt
AM3003CW-50	Power Cable Assembly x 5mt
6 AM2514	Handle Kit
7 AM2516	Microswitch Standard Trigger
8 AM2516L	Microswitch Extended Trigger
9 AMSP1-1	Screw Pack
10 AMPA3541	Cable Support
11 AM1522	Cable Terminal Male
12 AM2578/L	Gun Plug Housing
13 AML1541	Gun Plug Screw
14 AMC1519	Gun Plug Nut
15 AM1523	Gun Plug Terminal Female

Part Number	Description
16 AM1528	Hybrid Gun Plug Body c/w Spring Pins
17 AM1524	Gun Plug 'O' Ring
18 AMLOR	Liner 'O' Ring
19 AM1826	Liner Retaining Nut
20 AMWS	Wear Parts Spanner
Optional Extra	
21 AMCLST-KITS	Combi-Liner Set-up kit

Welding with Soft Wires

For welding with Aluminum wires use a Combi-liner (page 49). Optimum installation is achieved when using the Combi-liner set-up kit.

M4 Air-Cooled Mig Welding Torch

Ratings:	350A CO ₂ , 320A mixed gas M21, EN60974-7 @ 60% duty cycle. 0.9mm-1.2mm wires
----------	---

The Arc M4 performance is superior to the Binzel® MB36 and delivers more power than an MB38.

An all-day production torch in solid wire and pulse Mig applications over 300 Amps.

ARC M HIGH PERFORMANCE MIG TORCH PACKAGES

M4 Torches are supplied with a Euro termination as standard and are supplied 'ready to weld' with all wear parts fitted.

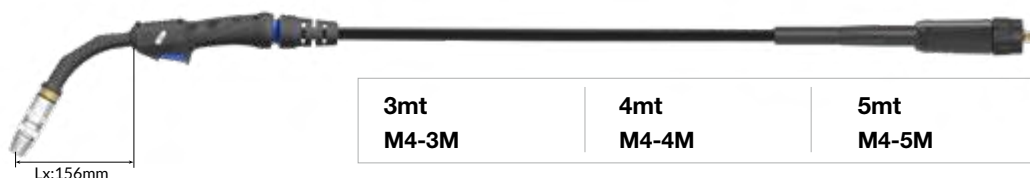

Wear Parts

Nozzles - 2 Piece

	Part Number	Description	Bore	Wall	Material
A	AM4HDTN	Tapered Nozzle (Part 2)	13mm	3mm	Copper
	•AM4HDCN	Conical Nozzle (Part 2)	15mm	3mm	Copper
	AM4HDCYN	Cylindrical Nozzle (Part 2)	21mm	3mm	Copper
A1	•AM4HDNI	Nozzle Insulator(Part 1)			Copper

Nozzles - Single Piece

A2	AM4TN	Tapered Nozzle / Insulator Assy	13mm	2.25mm	Copper
	AM4CN	Conical Nozzle / Insulator Assy	15mm	2.25mm	Copper
	AM4CYN	Cylindrical Nozzle / Insulator Assy	21mm	2.25mm	Copper

B Contact Tips

Part Number	Description	Size (mm)	Wire Size (mm-inch)	Material
Standard Series				
AM6WCT09	Contact Tip	M10*35.5	0.9 - 0.035	CuCrZr
AM6WCT10	Contact Tip	M10*35.5	1.0 - 0.040	CuCrZr
•AM6WCT12	Contact Tip	M10*35.5	1.2 - 0.045	CuCrZr
A Series				
AM6WCT10A	Contact Tip	M10*35.5	1.0 - 0.040	CuCrZr
AM6WCT12A	Contact Tip	M10*35.5	1.2 - 0.045	CuCrZr
AMC6WCT10A	Contact Tip	M10*35.5	1.0 - 0.040	Copper
AMC6WCT12A	Contact Tip	M10*35.5	1.2 - 0.045	Copper

C Tip Adaptors

Part Number	Description	Material
•AM4TAB	Tip Adaptor	Brass
AM4TAC	Tip Adaptor High Performance	CuCrZr

D Liners

Part Number	Description	Wire Size
•AM2524-30	Steel Liner x 3mt	1.0-1.2mm
•AM2524-40	Steel Liner x 4mt	1.0-1.2mm
•AM2524-50	Steel Liner x 5mt	1.0-1.2mm
AM1535-30	Steel Liner x 3mt	0.6-0.9mm
AM1535-40	Steel Liner x 4mt	0.6-0.9mm
AM1535-50	Steel Liner x 5mt	0.6-0.9mm

•Denotes torch package standard wear part set-up

SuperSoft -20 Premium Power Cables
Perfect for extreme subzero working conditions

® All Trademarks are the property of their respective owners and usage is for cross reference only

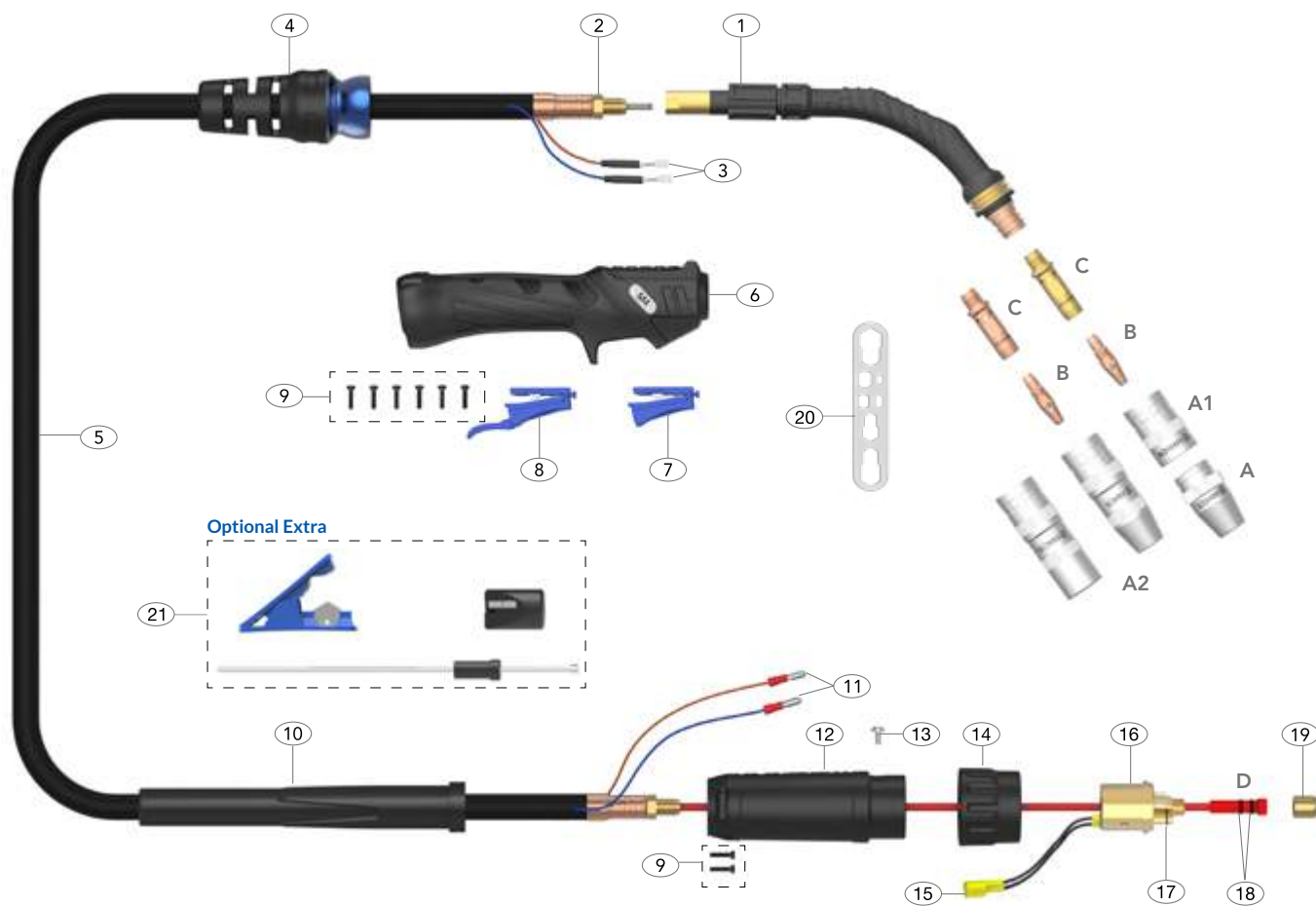

Spare Parts

Part Number	Description
1 AM4001	Swan Neck Assembly
2 AM1505	Lock Nut
3 AM1521	Cable Terminal
4 AM1514	Handle Cable Support c/w Ball Joint
5 AM4003CW-30	Power Cable Assembly x 3mt
AM4003CW-40	Power Cable Assembly x 4mt
AM4003CW-50	Power Cable Assembly x 5mt
6 AM2514	Handle Kit
7 AM2516	Microswitch Standard Trigger
8 AM2516L	Microswitch Extended Trigger
9 AMSP1-1	Screw Pack
10 AMPA3541	Cable Support
11 AM1522	Cable Terminal Male
12 AM2578/L	Gun Plug Housing
13 AM1526	Gun Plug Screw
14 AMC1519	Gun Plug Nut
15 AM1523	Gun Plug Terminal Female

Part Number	Description
16 AMB1528S	Gun Plug Body c/w Spring Pins
17 AM1524	Gun Plug 'O' Ring
18 AMLOR	Liner 'O' Ring
19 AM1826	Liner Retaining Nut
20 AMWS	Wear Parts Spanner
Optional Extra	
21 AMCLST-KITS	Combi-Liner Set-up kit

Welding with Soft Wires

For welding with Aluminum wires use a Combi-liner (page 49). Optimum installation is achieved when using the Combi-liner set-up kit.

M5 Air-Cooled Mig Welding Torch

Ratings:	390A CO ₂ , 360A mixed gas M21, EN60974-7 @ 60% duty cycle. 0.9mm-1.6mm wires
----------	---

Constructed for power, performance, and longevity the M5 is ideal for heavy duty 1.2mm and 1.6mm high deposition and pulse applications.

A retrofit heat shield is available for high reflected heat applications.



M5 Video

ARC M HIGH PERFORMANCE MIG TORCH PACKAGES

M5 Torches are supplied with a Euro termination as standard and are supplied 'ready to weld' with all wear parts fitted.

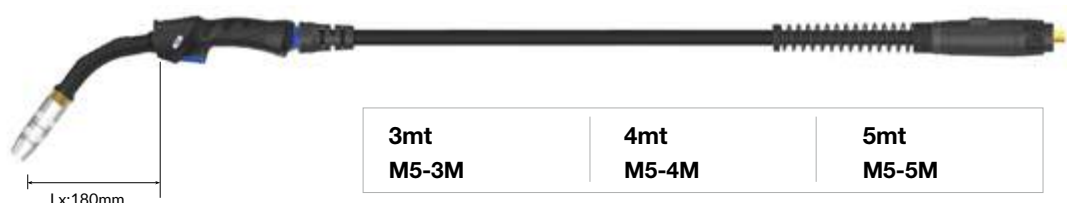

Wear Parts

Nozzle - 2 Piece

Part Number	Description	Bore	Wall	Material
A AM5HDTN	Tapered Nozzle - (Part 2)	13mm	3.5mm	Copper
•AM5HDCN	Conical Nozzle - (Part 2)	15mm	3.5mm	Copper
AM5HDCYN	Cylindrical Nozzle - (Part 2)	21mm	3.5mm	Copper
A1•AM5HDNI	Nozzle Insulator - (Part 1)			Copper

Nozzle - Single Piece

A2 AM5TN	Tapered Nozzle / Insulator Assy	13mm	2.5mm	Copper
AM5CN	Conical Nozzle / Insulator Assy	15mm	2.5mm	Copper
AM5CYN	Cylindrical Nozzle / Insulator Assy	21mm	2.5mm	Copper

B Contact Tips

Part Number	Description	Size (mm)	Wire Size (mm-inch)	Material
Standard Series				
AM6WCT09	Contact Tip	M10*35.5	0.9 - 0.035	CuCrZr
AM6WCT10	Contact Tip	M10*35.5	1.0 - 0.040	CuCrZr
•AM6WCT12	Contact Tip	M10*35.5	1.2 - 0.045	CuCrZr
AM6WCT14	Contact Tip	M10*35.5	1.4 - 0.055	CuCrZr
AM6WCT16	Contact Tip	M10*35.5	1.6 - 0.063	CuCrZr
AM6WCT20	Contact Tip	M10*35.5	2.0 - 0.080	CuCrZr
A Series				
AM6WCT10A	Contact Tip	M10*35.5	1.0 - 0.040	CuCrZr
AM6WCT12A	Contact Tip	M10*35.5	1.2 - 0.045	CuCrZr
AM6WCT16A	Contact Tip	M10*35.5	1.6 - 0.063	CuCrZr
AMC6WCT10A	Contact Tip	M10*35.5	1.0 - 0.040	Copper
AMC6WCT12A	Contact Tip	M10*35.5	1.2 - 0.045	Copper

Tip Adaptors

Part Number	Description	Material
AM5TAC	Tip Adaptor High Performance	CuCrZr
•AM5TAB	Tip Adaptor	Brass

D Liners

Part Number	Description	Wire Size
•AM6SL-1012-30	Steel Liner x 3mt	1.0-1.2mm
•AM6SL-1012-40	Steel Liner x 4mt	1.0-1.2mm
•AM6SL-1012-50	Steel Liner x 5mt	1.0-1.2mm
AM6SL-16-30	Steel Liner x 3mt	1.6mm
AM6SL-16-40	Steel Liner x 4mt	1.6mm
AM6SL-16-50	Steel Liner x 5mt	1.6mm

• Denotes torch package standard wear part set-up

SuperSoft -20 Premium Power Cables
Perfect for extreme subzero working conditions

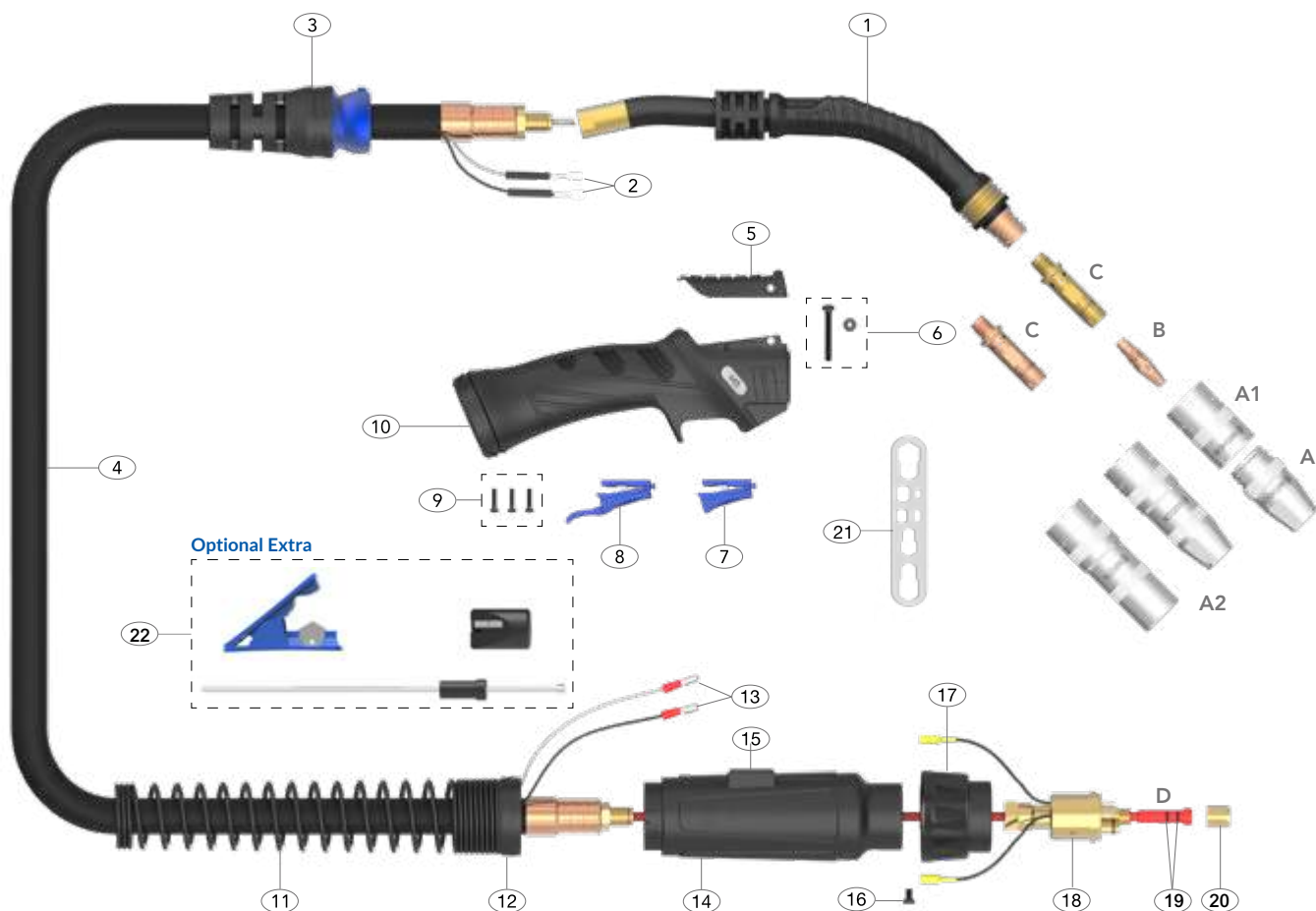

Spare Parts

Part Number	Description
1 AM5001	Swan Neck Assembly
2 AM1521	Cable Terminal
3 AMS8017	Handle Cable Support c/w Ball Joint
4 AM5003CW-30	Power Cable Assembly x 3mt
AM5003CW-40	Power Cable Assembly x 4mt
AM5003CW-50	Power Cable Assembly x 5mt
5 AM2515-C	Handle Control Cover
6 AMDMNS	Screw and Nut
7 AM2516	Microswitch Standard Trigger
8 AM2516L	Microswitch Extended Trigger
9 AMSP1-1	Screw Pack
10 AM2515	Handle and Lock Nut Assembly
11 AM8026	Housing Spring
12 AM8028	Housing Lock Nut
13 AM1522	Cable Terminal Male

Part Number	Description
14 AMT5022	Gun Plug Housing
15 AMF8017	Large Housing Flat Cover Block
16 AM1526	Gun Plug Screw
17 AM1519	Gun Plug Nut
18 AMB1528	Gun Plug Body
19 AMLOR	Liner 'O' Ring
20 AM1826	Liner Retaining Nut
21 AMWS	Wear Parts Spanner
Optional Extra	
22 AMCLST-KITS	Combi-Liner Set-up kit

Welding with Soft Wires

For welding with Aluminum wires use a Combi-liner (page 49-50). Optimum installation is achieved when using the Combi-liner set-up kit.

M6 Air-Cooled Mig Welding Torch

Ratings:	430A CO ₂ , 400A mixed gas M21, EN60974-7 @ 60% duty cycle. 0.9mm-2.0mm wires
----------	---

An Indestructible 400 Amp Air-Cooled Production Torch.

Perfect for high amps, high deposition, pulse, and high duty applications with 1.2mm and 1.6mm wires.

A retrofit heat shield is available for high reflected heat applications.

ARC M HIGH PERFORMANCE MIG TORCH PACKAGES

M6 Torches are supplied with a Euro termination as standard and are supplied 'ready to weld' with all wear parts fitted.

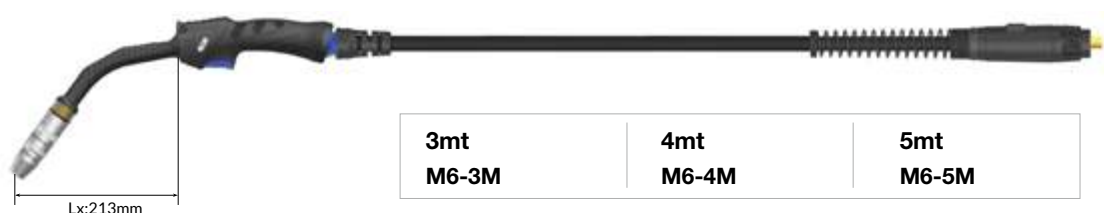

Wear Parts

Nozzle - 2 Piece

Part Number	Description	Bore	Wall	Material
A AM6HDTN	Tapered Nozzle (Part 2)	13mm	3.5mm	Copper
•AM6HDCN	Conica Nozzle (Part 2)	15mm	3.5mm	Copper
AM6HDCYN	Cylindrical Nozzle (Part 2)	23mm	3.5mm	Copper
A1•AM6HDNI	Nozzle Insulator(Part 1)			Copper

Nozzle - Single Piece

A2 AM6TN	Tapered Nozzle / Insulator Assy	13mm	2.5mm	Copper
AM6CN	Conical Nozzle / Insulator Assy	15mm	2.5mm	Copper
AM6CYN	Cylindrical Nozzle / Insulator Assy	23mm	2.5mm	Copper

B Contact Tips

Part Number	Description	Size (mm)	Wire Size (mm-inch)	Material
Standard Series				
AM6CT09	Contact Tip	M12*40.5	0.9 - 0.035	CuCrZr
AM6CT10	Contact Tip	M12*40.5	1.0 - 0.040	CuCrZr
•AM6CT12	Contact Tip	M12*40.5	1.2 - 0.045	CuCrZr
AM6CT14	Contact Tip	M12*40.5	1.4 - 0.055	CuCrZr
AM6CT16	Contact Tip	M12*40.5	1.6 - 0.063	CuCrZr
AM6CT20	Contact Tip	M12*40.5	2.0 - 0.080	CuCrZr
A Series				
AM6CT10A	Contact Tip	M12*40.5	1.0 - 0.040	CuCrZr
AM6CT12A	Contact Tip	M12*40.5	1.2 - 0.045	CuCrZr
AM6CT16A	Contact Tip	M12*40.5	1.6 - 0.063	CuCrZr
AM6CT20A	Contact Tip	M12*40.5	2.0 - 0.080	CuCrZr
AMC6CT10A	Contact Tip	M12*40.5	1.0 - 0.040	Copper
AMC6CT12A	Contact Tip	M12*40.5	1.2 - 0.045	Copper

C Tip Adaptors

Part Number	Description	Material
•AM6TAC	Tip Adaptor High Performance	CuCrZr
AM6TAB	Tip Adaptor	Brass

D Liners

Part Number	Description	Wire Size
•AM6SL-1012-30	Steel Liner x 3mt	1.0-1.2mm
•AM6SL-1012-40	Steel Liner x 4mt	1.0-1.2mm
•AM6SL-1012-50	Steel Liner x 5mt	1.0-1.2mm
AM6SL-16-30	Steel Liner x 3mt	1.6mm
AM6SL-16-40	Steel Liner x 4mt	1.6mm
AM6SL-16-50	Steel Liner x 5mt	1.6mm

• Denotes torch package standard wear part set-up

SuperSoft -20 Premium Power Cables
Perfect for extreme subzero working conditions

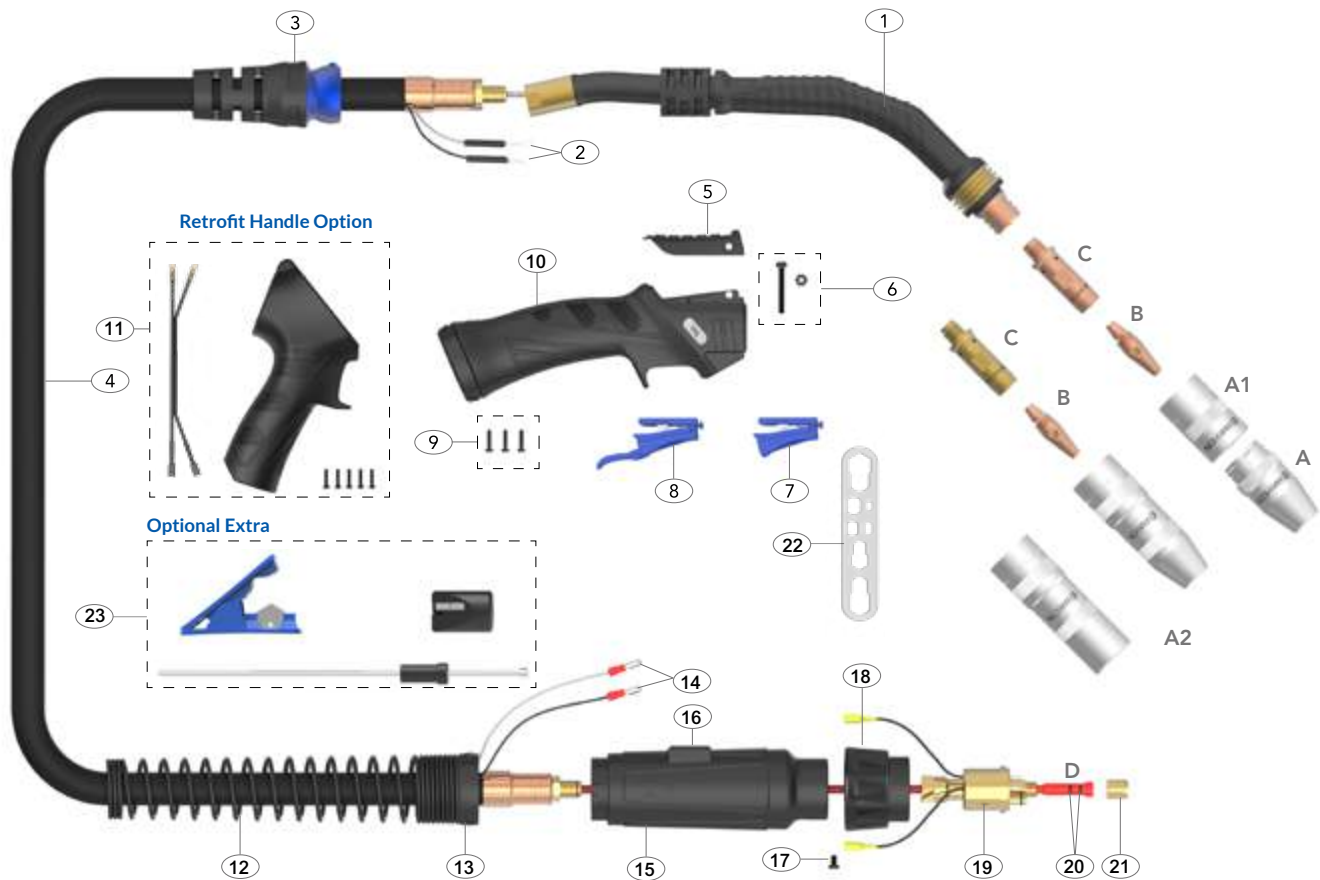

Spare Parts

Part Number	Description
1 AM6001	Swan Neck Assembly
2 AM1521	Cable Terminal
3 AMS8017	Handle Cable Support c/w Ball Joint
4 AM6003CW-30	Power Cable Assembly x 3mt
AM6003CW-40	Power Cable Assembly x 4mt
AM6003CW-50	Power Cable Assembly x 5mt
5 AM2515-C	Handle Control Cover
6 AMDMNS	Screw and Nut
7 AM2516	Microswitch Standard Trigger
8 AM2516L	Microswitch Extended Trigger
9 AMSP1-1	Screw Pack
10 AM2515	Handle and Lock Nut Assembly
12 AM8026	Housing Spring
13 AM8028	Housing Lock Nut
14 AM1522	Cable Terminal Male
15 AMT5022	Gun Plug Housing
16 AMF8017	Large Housing Wire Cover
17 AM1526	Gun Plug Screw
18 AM1519	Gun Plug Nut
19 AMB1528	Gun Plug Body
20 AMLOR	Liner 'O' Ring

Part Number	Description
21 AM1826	Liner Retaining Nut
22 AMWS	Wear Parts Spanner
Optional Extra	
23 AMCLST-KITS	Combi-Liner Set-up kit

Retrofit Handle Option

Part Number	Description
11 AMMP2515	Pistol Handle Assembly

Welding with Soft Wires

For welding with Aluminum wires use a Combi-liner (page 49-50). Optimum installation is achieved when using the Combi-liner set-up kit.

M5W Liquid-Cooled Mig Welding Torch

Ratings:	560A CO ₂ , 540A mixed gas M21, 380A pulse @100% Max. Load 24KW with 1600W liquid cooler, 0.9mm-1.6mm wires
	540A CO ₂ , 520A mixed gas M21, 350A pulse @100% Max. Load 22KW with 1200W liquid cooler, 0.9mm-1.6mm wires

Ideal for heavy duty 1.2mm high deposition and pulse applications with all wire types



M5W Video

Compact Handle

ARC M HIGH PERFORMANCE MIG TORCH PACKAGES

M5W Torches are supplied with a Euro termination as standard and are supplied 'ready to weld' with all wear parts fitted.

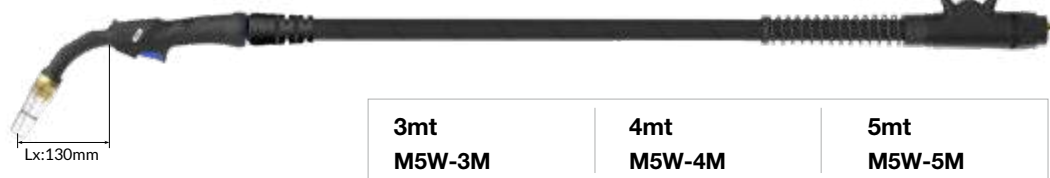

Wear Parts

Nozzles

Part Number	Description	Bore	Wall	Material
A •AMN5WCN	Conical / Insulator Assy	13.5mm	3.0mm	Copper
AMN5WTN	Tapered / Insulator Assy	11.5mm	3.0mm	Copper
AMN5WCYN	Cylindrical / Insulator Assy	16.0mm	3.0mm	Copper
A1•AMN5WCN-C	Conical Nozzle c/w Insulator & Retaining Ring			
AMN5WTN-C	Tapered Nozzle c/w Insulator & Retaining Ring			
AMN5WCYN-C	Cylindrical Nozzle c/w Insulator & Retaining Ring			

B Nozzle Retaining Rings

Part Number	Description	Size	Material
•AMN5WCNR	Nozzle Retaining Ring	29.5mm	Brass

C Contact Tips

Part Number	Description	Size (mm)	Wire Size (mm-inch)	Material
Standard Series				
AM5CT09	Contact Tip	M8*29.5	0.9 - 0.035	CuCrZr
AM5CT10	Contact Tip	M8*29.5	1.0 - 0.040	CuCrZr
•AM5CT12	Contact Tip	M8*29.5	1.2 - 0.045	CuCrZr
AM5CT14	Contact Tip	M8*29.5	1.4 - 0.055	CuCrZr
AM5CT16	Contact Tip	M8*29.5	1.6 - 0.063	CuCrZr
A Series				
AM5CT10A	Contact Tip	M8*29.5	1.0 - 0.040	CuCrZr
AM5CT12A	Contact Tip	M8*29.5	1.2 - 0.045	CuCrZr
AM5CT16A	Contact Tip	M8*29.5	1.6 - 0.063	CuCrZr
AM2CT10A	Contact Tip	M8*29.5	1.0 - 0.040	Copper
AM2CT12A	Contact Tip	M8*29.5	1.2 - 0.045	Copper

D Tip Adaptors

Part Number	Description	Material
•AM5WTAC-20	High Performance 2.0mm Recess	Copper
AM5WTAC-45	High Performance 4.5mm Recess	Copper
AM5WTAB-20	Tip Adaptor 2.0mm Recess	Brass
AM5WTAB-45	Tip Adaptor 4.5mm Recess	Brass

E Tip Adaptor Insulators

Part Number	Description
•AM5WTAI	Tip Adaptor Insulator

F Liners

Part Number	Description	Wire Size
•AM6SL-1012-30	Steel Liner x 3mt	1.0-1.2mm
•AM6SL-1012-40	Steel Liner x 4mt	1.0-1.2mm
•AM6SL-1012-50	Steel Liner x 5mt	1.0-1.2mm
AM6SL-16-30	Steel Liner x 3mt	1.6mm
AM6SL-16-40	Steel Liner x 4mt	1.6mm
AM6SL-16-50	Steel Liner x 5mt	1.6mm
AM6OSWL-1012-30	Soft Wire Liner x 3mt	1.0-1.2mm
AM6OSWL-1012-40	Soft Wire Liner x 4mt	1.0-1.2mm
AM6OSWL-1620-30	Soft Wire Liner x 3mt	1.6-2.0mm
AM6OSWL-1620-40	Soft Wire Liner x 4mt	1.6-2.0mm

For alternate liner options please refer to page 48-50

•Denotes torch package standard wear part set-up

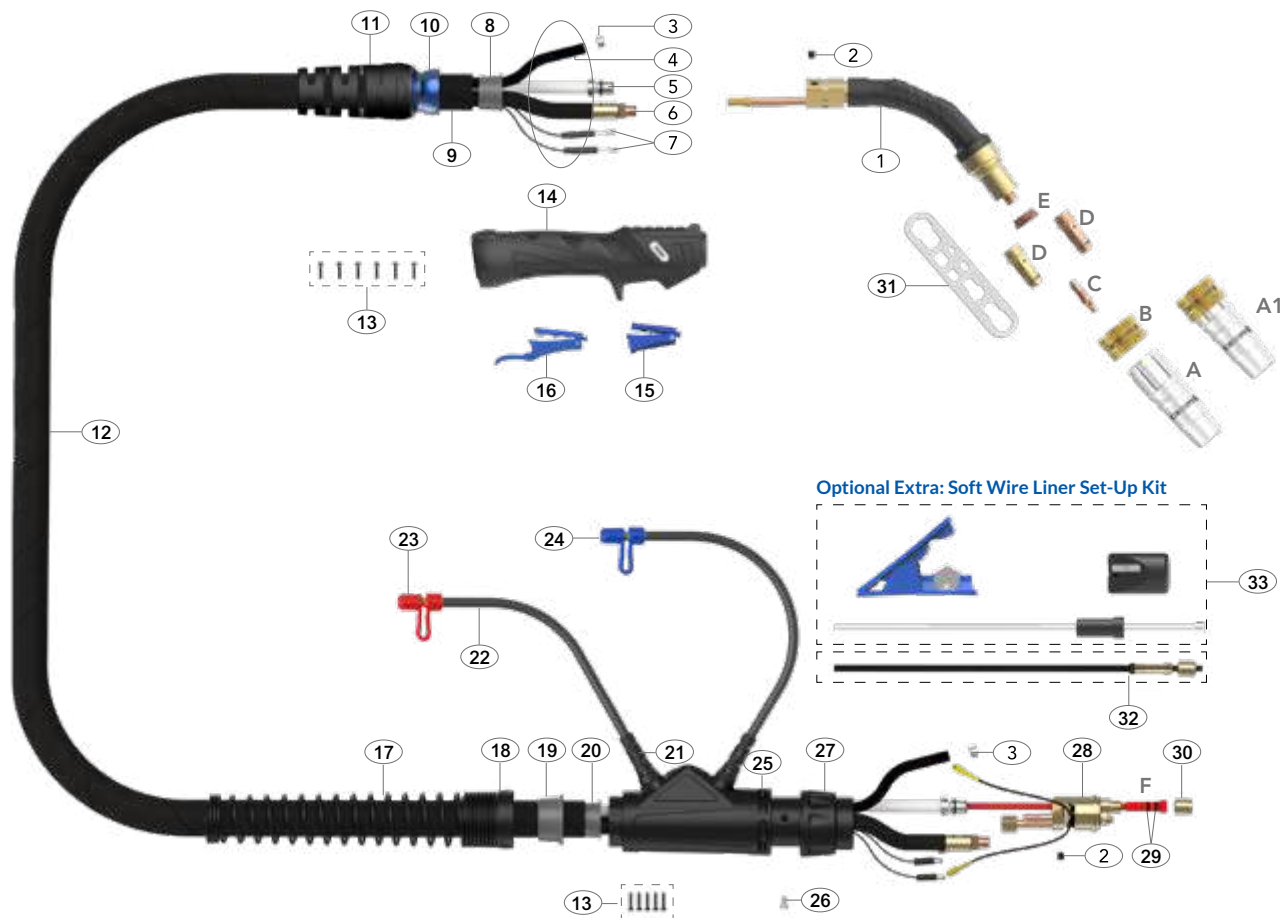

Spare Parts

Part Number	Description
1 AM5002	Swan Neck Assembly
2 AM6X5	Outer Liner Retaining Screw
3 AM15400023	Water Hose Clamp 10mm
8 AMS8010	Canvas Cover Retainer
10 AMS3208-1	Ball Joint
11 AMS3208-S	Cable Support With Nut
13 AMSP1-1	Screw Pack
14 AMM2514	Handle Kit
15 AM2516	Microswitch Standard Trigger
16 AM2516L	Microswitch Extended Trigger
17 AM8027	Cable Support Spring
18 AM8028	Housing Lock Nut
19 AM8009	Canvas Cover Clamp
20 AM8010	Canvas Cover Retainer
21 AM1820	Hose Support
22 AM5017	Water Outlet Hose Assembly
23 AM80320	Red Cap Stopper
24 AM80310	Blue Cap Stopper
25 AM5022	Housing Assembly
26 AM1526	Gun Plug Screw (M4 x 0.7)
27 AM1519	Gun Plug Nut
28 AM5098	Water-Cooled Plug Body Assembly
29 AMLOR	Liner 'O' Ring
30 AM1826	Liner Retaining Nut
31 AMWS	Wear Parts Spanner

Part Number	Description
Optional Extra	
32 AMOSWLK	Soft Wire Liner Gasket
33 AMOSW-LINER-T	Soft Wire / Combi-Liner Set-up Kit

Cable Parts

Description	Part Number		
	3mt	4mt	5mt
4 Water Inlet Hose Assembly	AM5012-30	AM5012-40	AM5012-50
5 Outer Liner Assembly	AM6008-30	AM6008-40	AM6008-50
6 Power Cable Assembly	AM6015-30	AM6015-40	AM6015-50
7 Switch Lead Assembly	AM5010-30	AM5010-40	AM5010-50
9 Canvas Cover Assembly	AM5019-30	AM5019-40	AM5019-50
12 Complete Cable Assembly	AM5506-30	AM5506-40	AM5506-50

Welding with Soft Wires

For welding with Aluminum wires use a Soft Wire / Combi-Liner (page 49-50). Optimum installation is achieved when using the Soft Wire / Combi-Liner set-up kit.

M55W Liquid-Cooled Mig Welding Torch

Ratings:	580A CO ₂ , 560A mixed gas M21, 400A pulse @100% Max. Load 25KW with 1600W liquid cooler, 0.9mm-2.0mm wires
	550A CO ₂ , 530A mixed gas M21, 360A pulse @100% Max. Load 23KW with 1200W liquid cooler, 0.9mm-2.0mm wires

Ideal for all high deposition applications with high reflected heat

ARC M HIGH PERFORMANCE MIG TORCH PACKAGES

M55W Torches are supplied with a Euro termination as standard and are supplied 'ready to weld' with an M10 set-up.

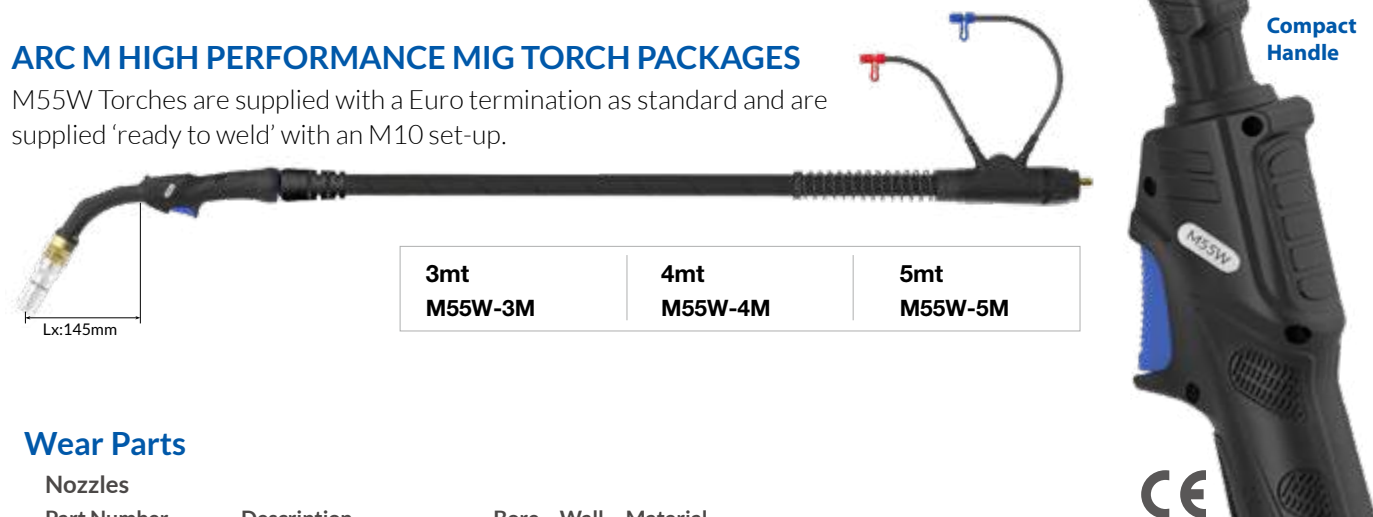

3mt
M55W-3M

4mt
M55W-4M

5mt
M55W-5M

Wear Parts

Nozzles

Part Number	Description	Bore	Wall	Material
A • AMN55WCN	Conical / Insulator Assy	15mm	3.0mm	Copper
AMN55WTN	Tapered / Insulator Assy	13mm	3.0mm	Copper
AMN55WCYN	Cylindrical/Insulator Assy	17mm	3.0mm	Copper
A1 • AMN55WCN-C	Conical Nozzle c/w Insulator & Retaining Ring			
AMN55WTN-C	Tapered Nozzle c/w Insulator & Retaining Ring			
AMN55WCYN-C	Cylindrical Nozzle c/w Insulator & Retaining Ring			

B Nozzle Retaining Rings

Part Number	Description	Size	Material
• AMN6WCNR	Nozzle Retaining Ring-Pull Off	30.5mm	Brass

C Contact Tips

Part Number	Description	Size (mm)	Wire Size (mm-inch)	Material
Standard Series				
AM6WCT09	Contact Tip	M10*35.5	0.9 - 0.035	CuCrZr
AM6WCT10	Contact Tip	M10*35.5	1.0 - 0.040	CuCrZr
• AM6WCT12	Contact Tip	M10*35.5	1.2 - 0.045	CuCrZr
AM6WCT14	Contact Tip	M10*35.5	1.4 - 0.055	CuCrZr
AM6WCT16	Contact Tip	M10*35.5	1.6 - 0.063	CuCrZr
AM6WCT20	Contact Tip	M10*35.5	2.0 - 0.080	CuCrZr
A Series				
AM6WCT10A	Contact Tip	M10*35.5	1.0 - 0.040	CuCrZr
AM6WCT12A	Contact Tip	M10*35.5	1.2 - 0.045	CuCrZr
AM6WCT16A	Contact Tip	M10*35.5	1.6 - 0.063	CuCrZr
AM6WCT20A	Contact Tip	M10*35.5	2.0 - 0.080	CuCrZr
AMC6WCT10A	Contact Tip	M10*35.5	1.0 - 0.040	Copper
AMC6WCT12A	Contact Tip	M10*35.5	1.2 - 0.045	Copper

• Denotes torch package standard wear part set-up

D Tip Adaptors

Part Number	Description	Material
• AM6OSWTAC-20	High Performance 2.0mm Recess	Copper
AM6OSWTAC-45	High Performance 4.5mm Recess	Copper
AM6OSWTAB-20	Tip Adaptor 2.0mm Recess	Brass
AM6OSWTAB-45	Tip Adaptor 4.5mm Recess	Brass

E Tip Adaptor Insulators

Part Number	Description
• AM55WTAI	Tip Adaptor Insulator

F Liners

Part Number	Description	Wire Size
• AM6SL-1012-30	Steel Liner x 3mt	1.0-1.2mm
• AM6SL-1012-40	Steel Liner x 4mt	1.0-1.2mm
• AM6SL-1012-50	Steel Liner x 5mt	1.0-1.2mm
AM6SL-16-30	Steel Liner x 3mt	1.6mm
AM6SL-16-40	Steel Liner x 4mt	1.6mm
AM6SL-16-50	Steel Liner x 5mt	1.6mm
AM6SL-20-30	Steel Liner x 3mt	2.0mm
AM6SL-20-40	Steel Liner x 4mt	2.0mm
AM6SL-20-50	Steel Liner x 5mt	2.0mm
AM6OSWL-1012-30	Soft Wire Liner x 3mt	1.0-1.2mm
AM6OSWL-1012-40	Soft Wire Liner x 4mt	1.0-1.2mm
AM6OSWL-1620-30	Soft Wire Liner x 3mt	1.6-2.0mm
AM6OSWL-1620-40	Soft Wire Liner x 4mt	1.6-2.0mm

For alternate liner options please refer to page 48-50

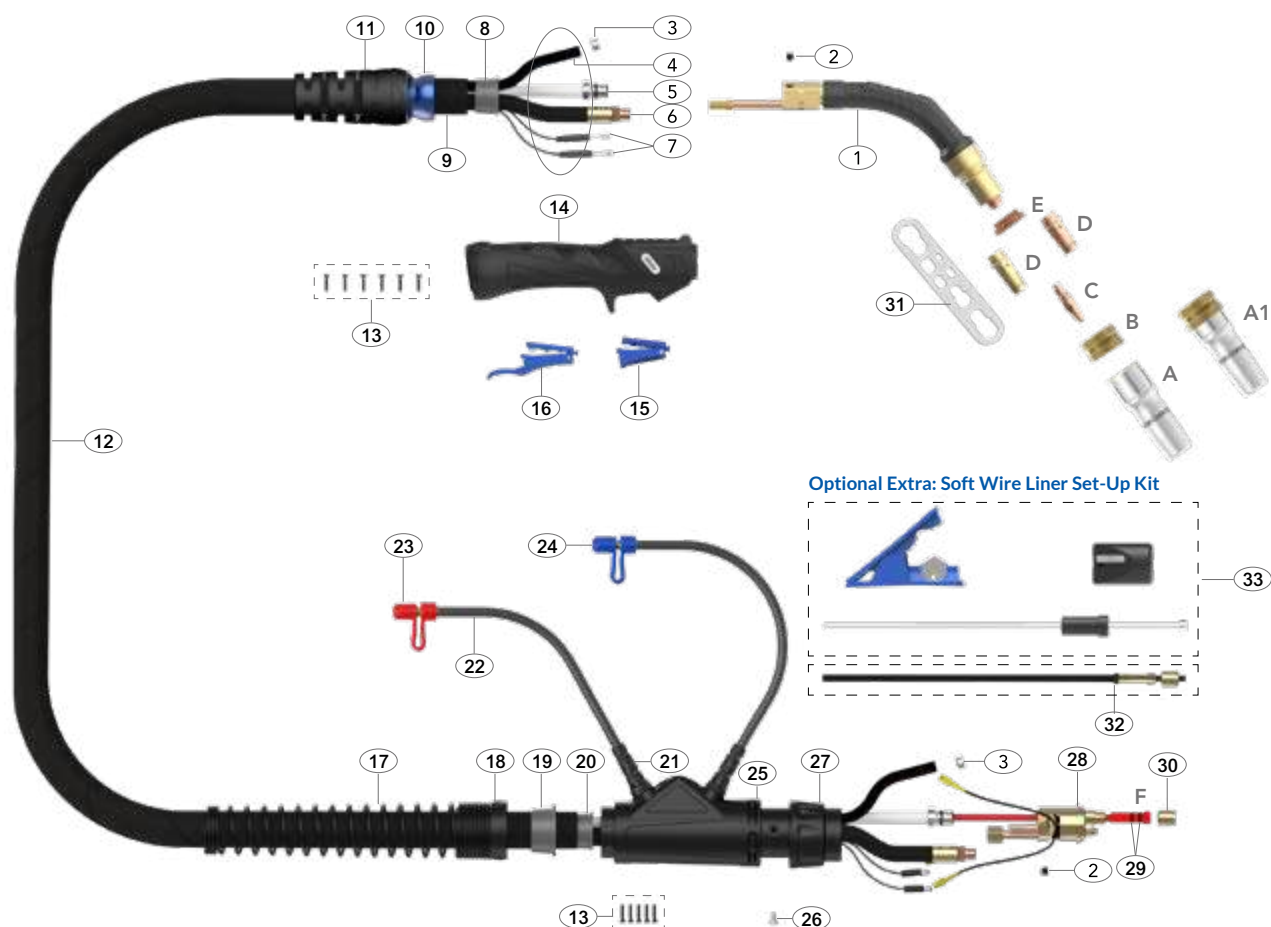

Spare Parts

Part Number	Description
1 AM5502	Swan Neck Assembly
2 AM6X5	Outer Liner Retaining Screw
3 AM15400023	Water Hose Clamp 10mm
8 AMS8010	Canvas Cover Retainer
10 AMS3208-1	Ball Joint
11 AMS3208-S	Cable Support With Nut
13 AMSP1-1	Screw Pack
14 AMM2514	Handle Kit
15 AM2516	Microswitch Standard Trigger
16 AM2516L	Microswitch Extended Trigger
17 AM8027	Cable Support Spring
18 AM8028	Housing Lock Nut
19 AM8009	Canvas Cover Clamp
20 AM8010	Canvas Cover Retainer
21 AM1820	Hose Support
22 AM5017	Water Outlet Hose Assembly
23 AM80320	Red Cap Stopper
24 AM80310	Blue Cap Stopper
25 AM5022	Housing Assembly
26 AM1526	Gun Plug Screw (M4 x 0.7)
27 AM1519	Gun Plug Nut
28 AM5098	Water-Cooled Plug Body Assembly
29 AMLOR	Liner 'O' Ring
30 AM1826	Liner Retaining Nut
31 AMWS	Wear Parts Spanner

Part Number	Description
Optional Extra	
32 AMOSWLK	Soft Wire Liner Gasket
33 AMOSW-LINER-T	Soft Wire / Combi-Liner Set-up Kit

Cable Parts

Description	Part Number		
	3mt	4mt	5mt
4 Water Inlet Hose Assembly	AM5012-30	AM5012-40	AM5012-50
5 Outer Liner Assembly	AM6008-30	AM6008-40	AM6008-50
6 Power Cable Assembly	AM6015-30	AM6015-40	AM6015-50
7 Switch Lead Assembly	AM5010-30	AM5010-40	AM5010-50
9 Canvas Cover Assembly	AM5019-30	AM5019-40	AM5019-50
12 Complete Cable Assembly	AM5506-30	AM5506-40	AM5506-50

Welding with Soft Wires

For welding with Aluminum wires use a Soft Wire / Combi-Liner (page 49-50). Optimum installation is achieved when using the Soft Wire / Combi-Liner set-up kit.

M65W/M65WS Liquid-Cooled Mig Welding Torch

M65W/ M65WS Ratings:	580A CO ₂ , 560A mixed gas M21, 400A pulse @100% Max. Load 25KW with 1600W liquid cooler, 0.9mm-2.0mm wires
	550A CO ₂ , 530A mixed gas M21, 360A pulse @100% Max. Load 23KW with 1200W liquid cooler, 0.9mm-2.0mm wires

Ideal for high deposition and pulse applications with high reflected heat.
Fitted with a long neck as standard with an optional shorter version.
A retrofit heat shield is available for high reflected heat applications.

ARC M HIGH PERFORMANCE MIG TORCH PACKAGES

M65W/WS Torches are supplied with a Euro termination as standard and are supplied 'ready to weld' with all wear parts fitted.

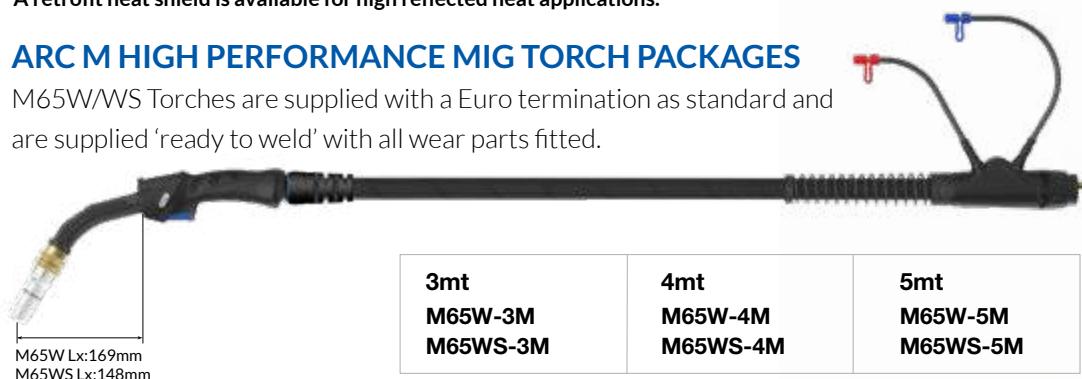

3mt M65W-3M M65WS-3M	4mt M65W-4M M65WS-4M	5mt M65W-5M M65WS-5M
---	---	---

Wear Parts

Nozzles

Part Number	Description	Bore	Wall	Material
A • AMN55WCN	Conical / Insulator Assy	15mm	3.0mm	Copper
AMN55WTN	Tapered / Insulator Assy	13mm	3.0mm	Copper
AMN55WCYN	Cylindrical/Insulator Assy	17mm	3.0mm	Copper
A1 • AMN55WCN-C	Conical Nozzle c/w Insulator & Retaining Ring			
AMN55WTN-C	Tapered Nozzle c/w Insulator & Retaining Ring			
AMN55WCYN-C	Cylindrical Nozzle c/w Insulator & Retaining Ring			

B Nozzle Retaining Rings

Part Number	Description	Size	Material
• AMN6WCNR	Nozzle Retaining Ring-Pull Off	30.5mm	Brass

C Contact Tips

Part Number	Description	Size (mm)	Wire Size (mm-inch)	Material
Standard Series				
AM6WCT09	Contact Tip	M10*35.5	0.9 - 0.035	CuCrZr
AM6WCT10	Contact Tip	M10*35.5	1.0 - 0.040	CuCrZr
• AM6WCT12	Contact Tip	M10*35.5	1.2 - 0.045	CuCrZr
AM6WCT14	Contact Tip	M10*35.5	1.4 - 0.055	CuCrZr
AM6WCT16	Contact Tip	M10*35.5	1.6 - 0.063	CuCrZr
AM6WCT20	Contact Tip	M10*35.5	2.0 - 0.080	CuCrZr
A Series				
AM6WCT10A	Contact Tip	M10*35.5	1.0 - 0.040	CuCrZr
AM6WCT12A	Contact Tip	M10*35.5	1.2 - 0.045	CuCrZr
AM6WCT16A	Contact Tip	M10*35.5	1.6 - 0.063	CuCrZr
AM6WCT20A	Contact Tip	M10*35.5	2.0 - 0.080	CuCrZr
AMC6WCT10A	Contact Tip	M10*35.5	1.0 - 0.040	Copper
AMC6WCT12A	Contact Tip	M10*35.5	1.2 - 0.045	Copper

• Denotes torch package standard wear part set-up

D Tip Adaptors

Part Number	Description	Material
• AM6OSWTAC-20	High Performance 2.0mm Recess	Copper
AM6OSWTAC-45	High Performance 4.5mm Recess	Copper
AM6OSWTAB-20	Tip Adaptor 2.0mm Recess	Brass
AM6OSWTAB-45	Tip Adaptor 4.5mm Recess	Brass

E Tip Adaptor Insulators

Part Number	Description
• AM55WTAI	Tip Adaptor Insulator

F Liners

Part Number	Description	Wire Size
• AM6SL-1012-30	Steel Liner x 3mt	1.0-1.2mm
• AM6SL-1012-40	Steel Liner x 4mt	1.0-1.2mm
• AM6SL-1012-50	Steel Liner x 5mt	1.0-1.2mm
AM6SL-16-30	Steel Liner x 3mt	1.6mm
AM6SL-16-40	Steel Liner x 4mt	1.6mm
AM6SL-16-50	Steel Liner x 5mt	1.6mm
AM6SL-20-30	Steel Liner x 3mt	2.0mm
AM6SL-20-40	Steel Liner x 4mt	2.0mm
AM6SL-20-50	Steel Liner x 5mt	2.0mm
AM6OSWL-1012-30	Soft Wire Liner x 3mt	1.0-1.2mm
AM6OSWL-1012-40	Soft Wire Liner x 4mt	1.0-1.2mm
AM6OSWL-1620-30	Soft Wire Liner x 3mt	1.6-2.0mm
AM6OSWL-1620-40	Soft Wire Liner x 4mt	1.6-2.0mm

For alternate liner options please refer to page 48-50

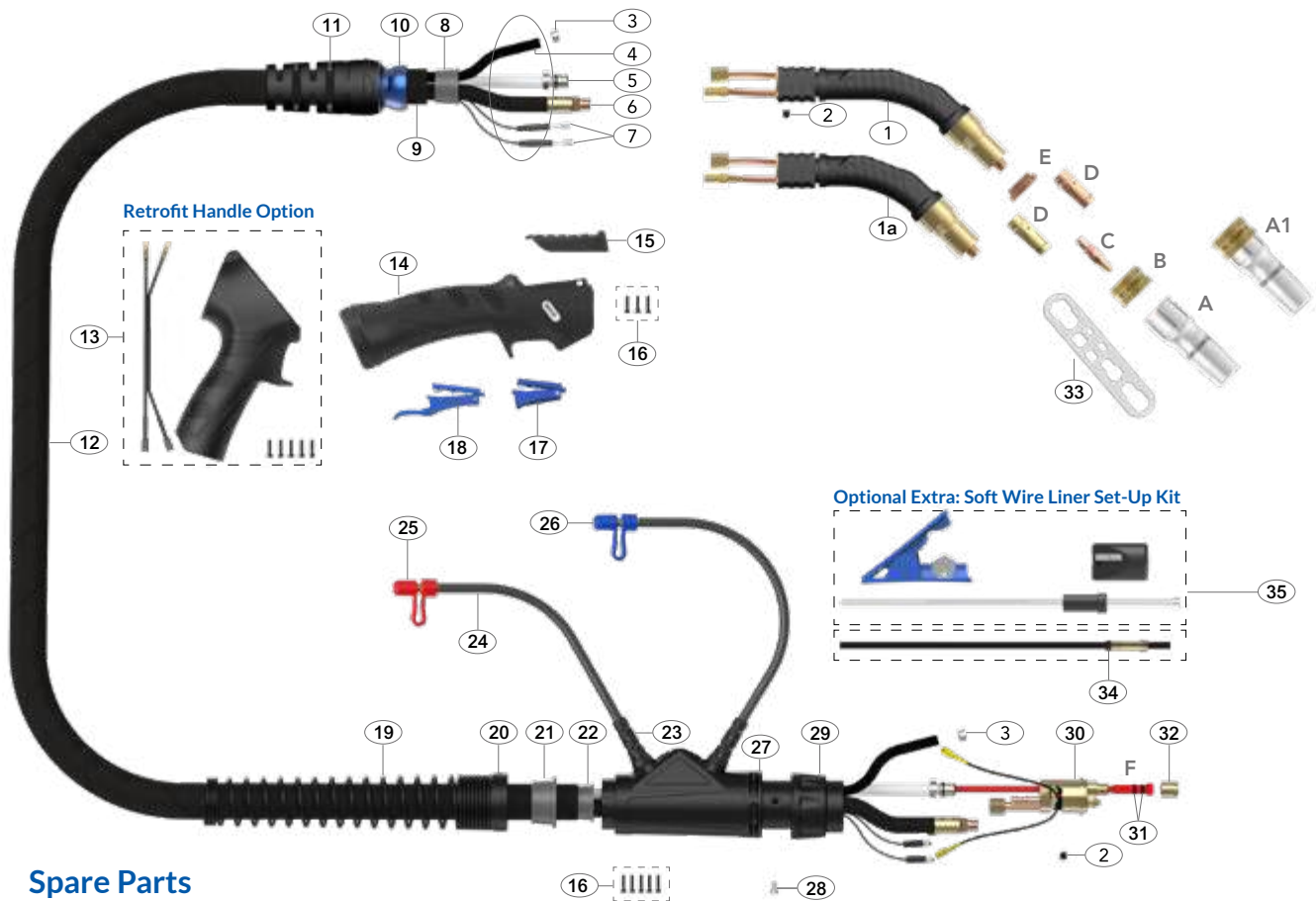

Spare Parts

Part Number	Description
1 AM6502	M65W Swan Neck Assembly 45°
1a AM6502S	M65WS Swan Neck Assembly 45°
2 AM6X5	Outer Liner Retaining Screw
3 AM15400023	Water Hose Clamp 10mm
8 AMS8010	Canvas Cover Retainer
10 AM3208-1	Ball Joint
11 AMS3208-S	Cable Support With Nut
14 AM2515	Handle and Lock Nut Assembly
15 AM2515-C	Handle Control Cover
16 AMSP1-1	Screw Pack
17 AM2516	Microswitch Standard Trigger
18 AM2516L	Microswitch Extended Trigger
19 AM8027	Cable Support Spring
20 AM8028	Housing Lock Nut
21 AM8009	Canvas Cover Clamp
22 AM8010	Canvas Cover Retainer
23 AM1820	Hose Support
24 AM5017	Water Outlet Hose Assembly
25 AM80320	Red Cap Stopper
26 AM80310	Blue Cap Stopper
27 AM5022	Housing Assembly
28 AM1526	Gun Plug Screw (M4 x 0.7)
29 AM1519	Gun Plug Nut
30 AM5098	Water-Cooled Plug Body Assembly
31 AMLOR	Liner 'O' Ring
32 AM1826	Liner Retaining Nut
33 AMWS	Wear Parts Spanner

Part Number	Description
Optional Extra	
34 AMOSWLK	Soft Wire Liner Gasket
35 AMOSW-LINER-T	Soft Wire / Combi-Liner Set-up Kit

Retrofit Handle Option

Part Number	Description
13 AMMP2515	Pistol Handle Assembly

Cable Parts

Description	Part Number		
	3mt	4mt	5mt
4 Water Inlet Hose Assembly	AM5012-30	AM5012-40	AM5012-50
5 Outer Liner Assembly	AM6008-30	AM6008-40	AM6008-50
6 Power Cable Assembly	AM6015-30	AM6015-40	AM6015-50
7 Switch Lead Assembly	AM5010-30	AM5010-40	AM5010-50
9 Canvas Cover Assembly	AM5019-30	AM5019-40	AM5019-50
12 Complete Cable Assembly	AM6006-30	AM6006-40	AM6006-50

Welding with Soft Wires

For welding with Aluminum wires use a Soft Wire / Combi-Liner (page 49-50). Optimum installation is achieved when using the Soft Wire / Combi-Liner set-up kit.

M65WLP Liquid-Cooled Mig Welding Torch

M65WLP Ratings:	590A CO ₂ , 570A mixed gas M21, 420A pulse @100%
	Max. Load 26KW with 1600W liquid cooler, 0.9mm-2.0mm wires
	560A CO ₂ , 530A mixed gas M21, 380A pulse @100%
	Max. Load 24KW with 1200W liquid cooler, 0.9mm-2.0mm wires

Ideal for high deposition and pulse applications with high reflected heat.

Suitable for larger wire sizes, the 22 degree neck is better for feeding both stiff and soft wires.

A retrofit heat shield is available for high reflected heat applications.

ARC M HIGH PERFORMANCE MIG TORCH PACKAGES

M65WLP Torches are supplied with a Euro termination as standard and is supplied with a pistol handle and 'ready to weld' with high performance M10 wear parts.



3mt
M65WLP-3M

4mt
M65WLP-4M

5mt
M65WLP-5M

*M65WLP supplied with high performance M10 wear parts.



Wear Parts

Nozzles

Part Number	Description	Bore	Wall	Material
A • AMN55WCN	Conical / Insulator Assy	15mm	3.0mm	Copper
AMN55WTN	Tapered / Insulator Assy	13mm	3.0mm	Copper
AMN55WCYN	Cylindrical/Insulator Assy	17mm	3.0mm	Copper
A1 • AMN55WCN-C	Conical Nozzle c/w Insulator & Retaining Ring			
AMN55WTN-C	Tapered Nozzle c/w Insulator & Retaining Ring			
AMN55WCYN-C	Cylindrical Nozzle c/w Insulator & Retaining Ring			

B Nozzle Retaining Rings

Part Number	Description	Size	Material
• AMN6WCNR	Nozzle Retaining Ring-Pull Off	30.5mm	Brass

C Contact Tips

Part Number	Description	Size (mm)	Wire Size (mm-inch)	Material
Standard Series				
AM6WCT09	Contact Tip	M10*35.5	0.9 - 0.035	CuCrZr
AM6WCT10	Contact Tip	M10*35.5	1.0 - 0.040	CuCrZr
• AM6WCT12	Contact Tip	M10*35.5	1.2 - 0.045	CuCrZr
AM6WCT14	Contact Tip	M10*35.5	1.4 - 0.055	CuCrZr
AM6WCT16	Contact Tip	M10*35.5	1.6 - 0.063	CuCrZr
AM6WCT20	Contact Tip	M10*35.5	2.0 - 0.080	CuCrZr
A Series				
AM6WCT10A	Contact Tip	M10*35.5	1.0 - 0.040	CuCrZr
AM6WCT12A	Contact Tip	M10*35.5	1.2 - 0.045	CuCrZr
AM6WCT16A	Contact Tip	M10*35.5	1.6 - 0.063	CuCrZr
AM6WCT20A	Contact Tip	M10*35.5	2.0 - 0.080	CuCrZr
AMC6WCT10A	Contact Tip	M10*35.5	1.0 - 0.040	Copper
AMC6WCT12A	Contact Tip	M10*35.5	1.2 - 0.045	Copper

• Denotes torch package standard wear part set-up

D Tip Adaptors

Part Number	Description	Material
• AM6OSWTAC-20	High Performance 2.0mm Recess	Copper
AM6OSWTAC-45	High Performance 4.5mm Recess	Copper
AM6OSWTAB-20	Tip Adaptor 2.0mm Recess	Brass
AM6OSWTAB-45	Tip Adaptor 4.5mm Recess	Brass

E Tip Adaptor Insulators

Part Number	Description
• AM55WTAI	Tip Adaptor Insulator

F Liners

Part Number	Description	Wire Size
• AM6SL-1012-30	Steel Liner x 3mt	1.0-1.2mm
• AM6SL-1012-40	Steel Liner x 4mt	1.0-1.2mm
• AM6SL-1012-50	Steel Liner x 5mt	1.0-1.2mm
AM6SL-16-30	Steel Liner x 3mt	1.6mm
AM6SL-16-40	Steel Liner x 4mt	1.6mm
AM6SL-16-50	Steel Liner x 5mt	1.6mm
AM6SL-20-30	Steel Liner x 3mt	2.0mm
AM6SL-20-40	Steel Liner x 4mt	2.0mm
AM6SL-20-50	Steel Liner x 5mt	2.0mm
AM6OSWL-1012-30	Soft Wire Liner x 3mt	1.0-1.2mm
AM6OSWL-1012-40	Soft Wire Liner x 4mt	1.0-1.2mm
AM6OSWL-1620-30	Soft Wire Liner x 3mt	1.6-2.0mm
AM6OSWL-1620-40	Soft Wire Liner x 4mt	1.6-2.0mm

For alternate liner options please refer to page 48-50

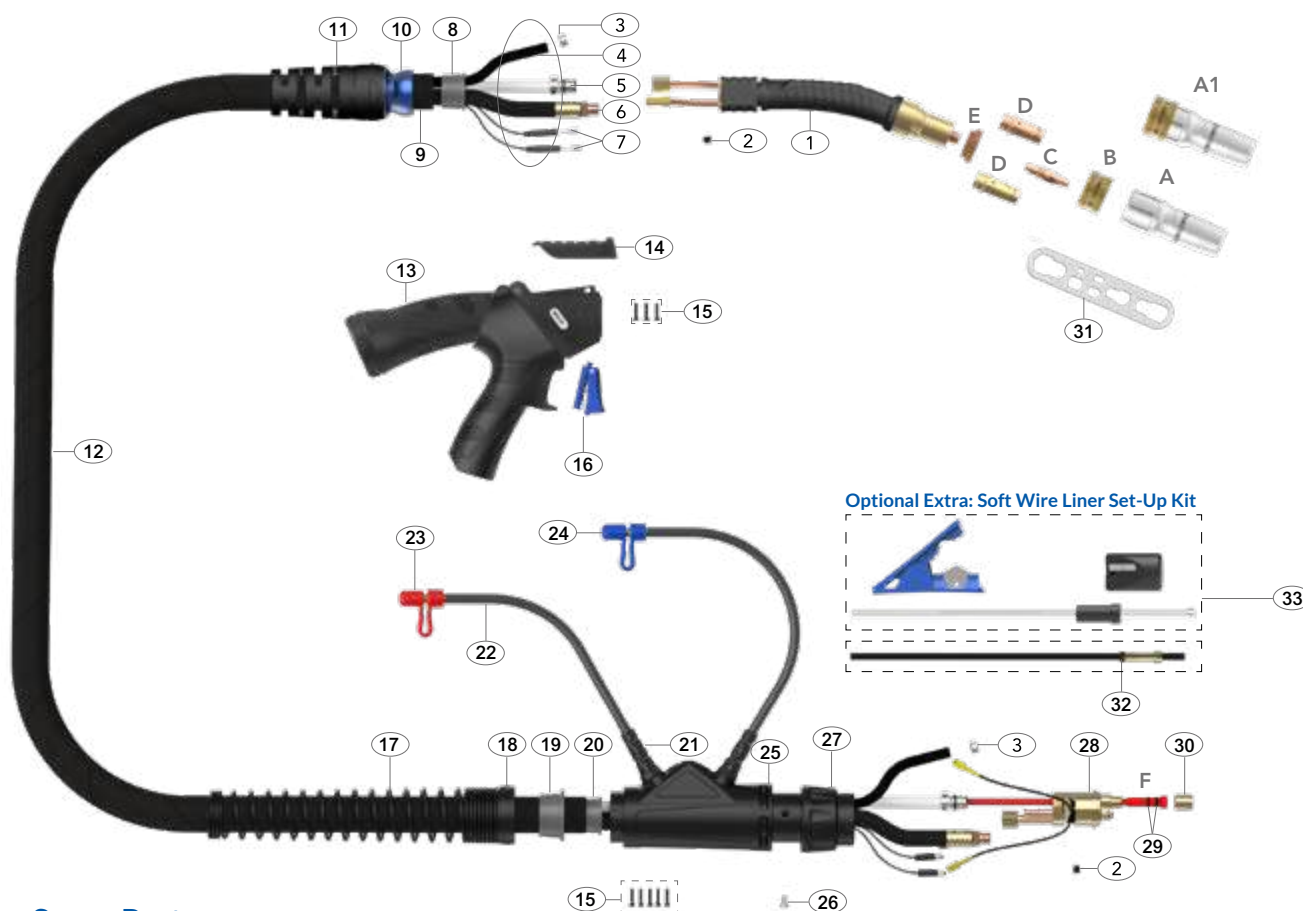

Spare Parts

Part Number	Description
1 AM6502P	M65WLP Swan Neck Assembly 22°
2 AM6X5	Outer Liner Retaining Screw
3 AM15400023	Water Hose Clamp 10mm
8 AMS8010	Canvas Cover Retainer
10 AM3208-1	Ball Joint
11 AMS3208-S	Cable Support With Nut
13 AMP2515-KJ	Handle and Lock Nut Assembly
14 AM2515-C	Handle Control Cover
15 AMSP1-1	Screw Pack
16 AM2516	Microswitch Standard Trigger
17 AM8027	Cable Support Spring
18 AM8028	Housing Lock Nut
19 AM8009	Canvas Cover Clamp
20 AM8010	Canvas Cover Retainer
21 AM1820	Hose Support
22 AM5017	Water Outlet Hose Assembly
23 AM80320	Red Cap Stopper
24 AM80310	Blue Cap Stopper
25 AM5022	Housing Assembly
26 AM1526	Gun Plug Screw (M4 x 0.7)
27 AM1519	Gun Plug Nut
28 AM5098	Water-Cooled Plug Body Assembly
29 AMLOR	Liner 'O' Ring
30 AM1826	Liner Retaining Nut
31 AMWS	Wear Parts Spanner

Part Number	Description
Optional Extra	
32 AMOSWLK	Soft Wire Liner Gasket
33 AMOSW-LINER-T	Soft Wire / Combi-Liner Set-up Kit

Cable Parts

Description	Part Number		
	3mt	4mt	5mt
4 Water Inlet Hose Assembly	AM5012-30	AM5012-40	AM5012-50
5 Outer Liner Assembly	AM6008-30	AM6008-40	AM6008-50
6 Power Cable Assembly	AM6015-30	AM6015-40	AM6015-50
7 Switch Lead Assembly	AM5010-30	AM5010-40	AM5010-50
9 Canvas Cover Assembly	AM5019-30	AM5019-40	AM5019-50
12 Complete Cable Assembly	AM6006-30	AM6006-40	AM6006-50

Welding with Soft Wires

For welding with Aluminum wires use a Soft Wire / Combi-Liner (page 49-50). Optimum installation is achieved when using the Soft Wire / Combi-Liner set-up kit.

M65WA Auto Liquid-Cooled Mig Welding Torch

Ratings:	580A CO ₂ , 560A mixed gas M21, 400A pulse @100% Max. Load 25KW with 1600W liquid cooler, 0.9mm-2.0mm wires
	550A CO ₂ , 530A mixed gas M21, 360A pulse @100% Max. Load 23KW with 1200W liquid cooler, 0.9mm-2.0mm wires

A double circuit Liquid-Cooled Auto torch ideal for continuous use at high amperages. Suitable for high deposition, pulse and larger wire sizes.

ARC M HIGH PERFORMANCE MIG TORCH PACKAGES

M65WA Auto Torches are supplied with a Euro termination as standard and is supplied with straight handle and 'ready to weld' with high performance M10 wear parts.

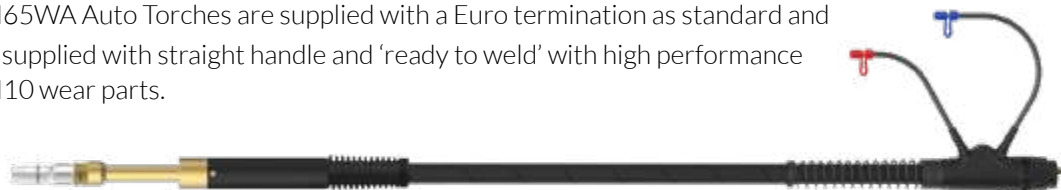

2mt	3mt	4mt
M65WA-2M	M65WA-3M	M65WA-4M
M65WA22-2M	M65WA22-3M	M65WA22-4M
M65WA45-2M	M65WA45-3M	M65WA45-4M

Wear Parts



Nozzles

Part Number	Description	Bore
A • AMN55WCN	Conical / Insulator Assy	15mm 3.0mm Copper
AMN55WTN	Tapered / Insulator Assy	13mm 3.0mm Copper
AMN55WCYN	Cylindrical/Insulator Assy	17mm 3.0mm Copper
A1 • AMN55WCN-C	Conical Nozzle c/w Insulator & Retaining Ring	
AMN55WTN-C	Tapered Nozzle c/w Insulator & Retaining Ring	
AMN55WCYN-C	Cylindrical Nozzle c/w Insulator & Retaining Ring	

B Nozzle Retaining Rings

Part Number	Description	Size	Material
• AMN6WCNR	Nozzle Retaining Ring-Pull Off	30.5mm	Brass

C Contact Tips

Part Number	Description	Size (mm)	Wire Size (mm-inch)	Material
Standard Series				
AM6WCT09	Contact Tip	M10*35.5	0.9 - 0.035	CuCrZr
AM6WCT10	Contact Tip	M10*35.5	1.0 - 0.040	CuCrZr
• AM6WCT12	Contact Tip	M10*35.5	1.2 - 0.045	CuCrZr
AM6WCT14	Contact Tip	M10*35.5	1.4 - 0.055	CuCrZr
AM6WCT16	Contact Tip	M10*35.5	1.6 - 0.063	CuCrZr
AM6WCT20	Contact Tip	M10*35.5	2.0 - 0.080	CuCrZr
A Series				
AM6WCT10A	Contact Tip	M10*35.5	1.0 - 0.040	CuCrZr
AM6WCT12A	Contact Tip	M10*35.5	1.2 - 0.045	CuCrZr
AM6WCT16A	Contact Tip	M10*35.5	1.6 - 0.063	CuCrZr
AM6WCT20A	Contact Tip	M10*35.5	2.0 - 0.080	CuCrZr
AMC6WCT10A	Contact Tip	M10*35.5	1.0 - 0.040	Copper
AMC6WCT12A	Contact Tip	M10*35.5	1.2 - 0.045	Copper

• Denotes torch package standard wear part set-up

D Tip Adaptors

Part Number	Description	Material
• AM6OSWTAC-20	High Performance 2.0mm Recess	Copper
AM6OSWTAC-45	High Performance 4.5mm Recess	Copper
AM6OSWTAB-20	Tip Adaptor 2.0mm Recess	Brass
AM6OSWTAB-45	Tip Adaptor 4.5mm Recess	Brass

E Tip Adaptor Insulators

Part Number	Description
• AM55WTAI	Tip Adaptor Insulator

F Liners

Part Number	Description	Wire Size
• AM6SL-1012-20	Steel Liner x 2mt	1.0-1.2mm
• AM6SL-1012-30	Steel Liner x 3mt	1.0-1.2mm
• AM6SL-1012-40	Steel Liner x 4mt	1.0-1.2mm
AM6SL-16-20	Steel Liner x 2mt	1.6mm
AM6SL-16-30	Steel Liner x 3mt	1.6mm
AM6SL-16-40	Steel Liner x 4mt	1.6mm
AM6SL-20-20	Steel Liner x 2mt	2.0mm
AM6SL-20-30	Steel Liner x 3mt	2.0mm
AM6SL-20-40	Steel Liner x 4mt	2.0mm
AM6OSWL-1012-20	Soft Wire Liner x 2mt	1.0-1.2mm
AM6OSWL-1012-30	Soft Wire Liner x 3mt	1.0-1.2mm
AM6OSWL-1012-40	Soft Wire Liner x 4mt	1.0-1.2mm
AM6OSWL-1620-20	Soft Wire Liner x 2mt	1.6-2.0mm
AM6OSWL-1620-30	Soft Wire Liner x 3mt	1.6-2.0mm
AM6OSWL-1620-40	Soft Wire Liner x 4mt	1.6-2.0mm

For alternate liner options please refer to page 48-50

HIGH PERFORMANCE SERIES



MAKE WORK
LIFE EASIER

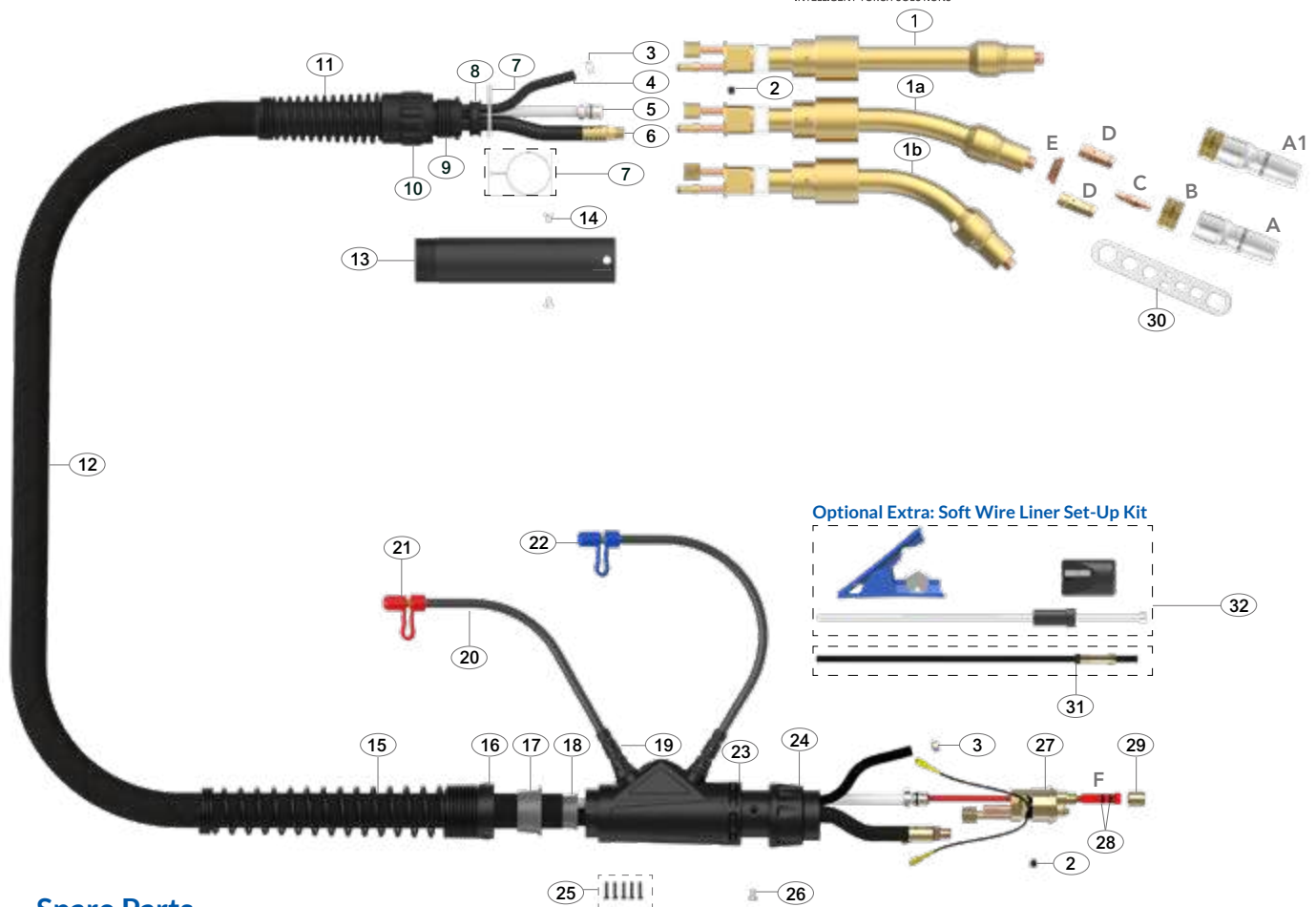

Spare Parts

Part Number	Description
1 AMA6002A	Auto Swan Neck Straight
1a AMA6002A22	Auto Swan Neck 22°
1b AMA6002A45	Auto Swan Neck 45°
2 AM6X5	Outer Liner Retaining Screw
3 AM15400023	Water Hose Clamp 10mm
7 AMWRID35	Wire Clamp
8 AMB8010	Canvas Cover Retainer
9 AMB8110A	Auto Handle Insert
10 AMB8030A	Auto Handle Lock Nut
11 AMB8017A	Auto Handle Spring
13 AMB3630	Auto Handle
14 AMB3629	Handle Screw
15 AM8027	Cable Support Spring
16 AM8028	Housing Lock Nut
17 AM8009	Canvas Cover Clamp
18 AM8010	Canvas Cover Retainer
19 AM1820	Hose Support
20 AM5017	Water Outlet Hose Assembly
21 AM80320	Red Cap Stopper
22 AM80310	Blue Cap Stopper
23 AM5022	Housing Assembly
24 AM1519	Gun Plug Nut
25 AMSP1-1	Screw Pack
26 AM1526	Gun Plug Screw (M4 x 0.7)
27 AM5098	Water-Cooled Plug Body Assembly

Part Number	Description
28 AMLOR	Liner 'O' Ring
29 AM1826	Liner Retaining Nut
30 AMWS	Wear Parts Spanner
Optional Extra	
31 AMOSWLK	Soft Wire Liner Gasket
32 AMOSW-LINER-T	Soft Wire / Combi-Liner Set-up Kit

Cable Parts

Description	Part Number		
	3mt	4mt	5mt
4 Water Inlet Hose Assembly	AM5012-20	AM5012-30	AM5012-40
5 Outer Liner Assembly	AUTO-AM6008-20	AUTO-AM6008-30	AUTO-AM6008-40
6 Power Cable Assembly	AM6015-20	AM6015-30	AM6015-40
12 Complete Cable Assembly	AUTO-AM6006-20	AUTO-AM6006-30	AUTO-AM6006-40

Welding with Soft Wires

For welding with Aluminum wires use a Soft Wire / Combi-Liner (page 49-50). Optimum installation is achieved when using the Soft Wire / Combi-Liner set-up kit.

Nozzles

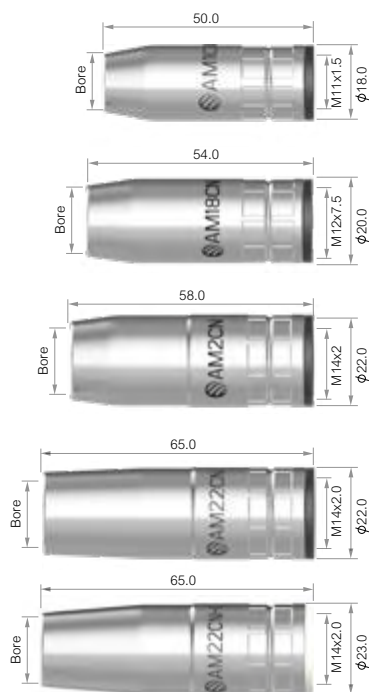

Part No.	Description	Bore	Wall	Material	M1	M18	M2	M22	M2M	M22M
AM1CN	Conical Nozzle Assembly	12mm	1.0mm	Copper	●	●	●	●	●	●
AM1TN	Tapered Nozzle Assembly	10.6mm	1.0mm	Copper	●	●	●	●	●	●
AM18CN	Conical Nozzle Assembly	14mm	1.5mm	Copper	●	●	●	●	●	●
AM18TN	Tapered Nozzle Assembly	12mm	1.5mm	Copper	●	●	●	●	●	●
AM2CN	Conical Nozzle Assembly	15mm	1.9mm	Copper	●	●	●	●	●	●
AM2TN	Tapered Nozzle Assembly	12mm	1.9mm	Copper	●	●	●	●	●	●
AM22CN	Conical Nozzle Assembly	16mm	1.75mm	Copper	●	●	●	●	●	●
AM22TN	Tapered Nozzle Assembly	14mm	1.75mm	Copper	●	●	●	●	●	●
Recommended for High Amperage and Pulse Welding										
AM22CNHD	Conical Nozzle HD Assembly	16mm	2.00mm	Copper	●	●	●	●	●	●

Contact Tips

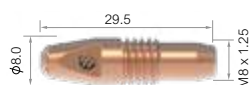
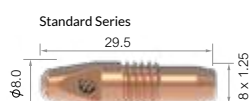

Part No.	Description	Size mm	Wire Size mm-inch	Material	M1	M18	M2	M22	M2M	M22M
Standard Series - Recommended for Fe, Fe-MC/FC Set-up										
AM1CT06	Contact Tip	M6*25.0	0.6-0.023	Copper	●	●	●	●	●	●
AM1CT08	Contact Tip	M6*25.0	0.8-0.030	Copper	●	●	●	●	●	●
AM1CT09	Contact Tip	M6*25.0	0.9-0.035	Copper	●	●	●	●	●	●
AM1CT10	Contact Tip	M6*25.0	1.0-0.040	Copper	●	●	●	●	●	●
AM1CT12	Contact Tip	M6*25.0	1.2-0.045	Copper	●	●	●	●	●	●
Standard Series - Recommended for Fe, Fe-MC/FC Set-up										
AM2CT08	Contact Tip	M8*29.5	0.8-0.030	Copper	●	●	●	●	●	●
AM2CT09	Contact Tip	M8*29.5	0.9-0.035	Copper	●	●	●	●	●	●
AM2CT10	Contact Tip	M8*29.5	1.0-0.040	Copper	●	●	●	●	●	●
AM2CT12	Contact Tip	M8*29.5	1.2-0.045	Copper	●	●	●	●	●	●
A Series - Recommended for Aluminium and SS Set-up										
AM1CT08A	Contact Tip	M6*25.0	0.8-0.030	Copper	●	●	●	●	●	●
AM1CT10A	Contact Tip	M6*25.0	1.0-0.040	Copper	●	●	●	●	●	●
AM1CT12A	Contact Tip	M6*25.0	1.2-0.045	Copper	●	●	●	●	●	●
A Series - Recommended for Aluminium and SS Set-up										
AM2CT08A	Contact Tip	M8*29.5	0.8-0.030	Copper	●	●	●	●	●	●
AM2CT10A	Contact Tip	M8*29.5	1.0-0.040	Copper	●	●	●	●	●	●
AM2CT12A	Contact Tip	M8*29.5	1.2-0.045	Copper	●	●	●	●	●	●

● Standard wear part range ● Torch package standard wear part set-up

Tip Adaptors



Part No.	Description	Material	M1	M18	M2	M22	M2M	M22M
AM1TA	Tip Adaptor	Brass	●	●	●	●	●	●



AM18TA	Tip Adaptor	Brass	●	●	●	●	●	●
--------	-------------	-------	---	---	---	---	---	---



AM2TA	Tip Adaptor	Brass	●	●	●	●	●	●
-------	-------------	-------	---	---	---	---	---	---



AM22TA	Tip Adaptor	Brass	●	●	●	●	●	●
--------	-------------	-------	---	---	---	---	---	---

● Standard wear part range ● Torch package standard wear part set-up

Liners

Filler Metal

Steel Liner Recommended for: Fe, Fe-MC/FC. Light and medium duty applications

Part No.	Description	Nipple	Wire Size mm	M1	M18	M2	M22	M2M	M22M
AM1535-30	Steel Liner x 3mt	Moulded Nipple	0.6-0.9	●	●	●	●	●	●
AM1535-40	Steel Liner x 4mt	Moulded Nipple	0.6-0.9	●	●	●	●	●	●
AM1535-50	Steel Liner x 5mt	Moulded Nipple	0.6-0.9	●	●	●	●	●	●



AM2524-30	Steel Liner x 3mt	Moulded Nipple	1.0-1.2	●	●	●	●	●	●
AM2524-40	Steel Liner x 4mt	Moulded Nipple	1.0-1.2	●	●	●	●	●	●
AM2524-50	Steel Liner x 5mt	Moulded Nipple	1.0-1.2	●	●	●	●	●	●



AM2MJL	Neck Jump Liner - Hard Wire(L:170mm)	Brass Nipple	0.8-1.2	●	●	●	●	●	●
AM22MJL	Neck Jump Liner - Hard Wire(L:186.5mm)	Brass Nipple	0.8-1.2	●	●	●	●	●	●



AI - Combi Liner Recommended for: Air-Cooled torches, Can be used for SS-MC/FC wires

AM1564-30	Combi-Liner x 3mt	Brass Nipple	0.8-1.2	●	●	●	●	●	●
AM1564-40	Combi-Liner x 4mt	Brass Nipple	0.8-1.2	●	●	●	●	●	●
AM1564-50	Combi-Liner x 5mt	Brass Nipple	0.8-1.2	●	●	●	●	●	●



AI - Soft Wire Liner Recommended for: Air-Cooled torches, Can be used for SS-MC/FC wires

AM1564A-30	Soft Wire Liner x 3mt	Brass Nipple	0.8-1.2	●	●	●	●	●	●
AM1564A-40	Soft Wire Liner x 4mt	Brass Nipple	0.8-1.2	●	●	●	●	●	●
AM1564A-50	Soft Wire Liner x 5mt	Brass Nipple	0.8-1.2	●	●	●	●	●	●



AM2MJL-B	Neck Jump Liner - Soft Wire(L:170mm)	Brass Nipple	0.8-1.2	●	●	●	●	●	●
AM22MJL-B	Neck Jump Liner - Soft Wire(L:186.5mm)	Brass Nipple	0.8-1.2	●	●	●	●	●	●



Welding with Soft Wires

For welding with Aluminum wires use a Combi-liner.
Optimum installation is achieved when using the Combi-liner set-up kit.

● Standard wear part range ● Torch package standard wear part set-up

Air-Cooled Nozzles - 2 Piece

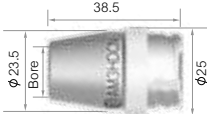
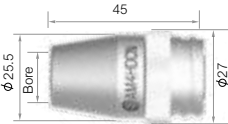
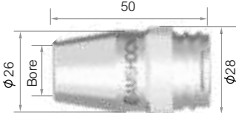
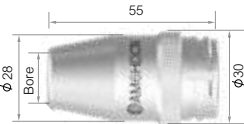
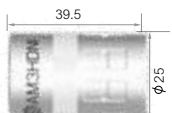
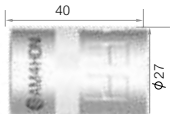
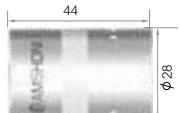
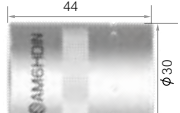
	Part No.	Description	Bore	Wall		M3	M4	M5	M6
	AM3HDTN	Tapered Nozzle	12mm	3mm	Copper	●	●	●	●
	AM3HDCN	Conical Nozzle	14mm	3mm	Copper	●	●	●	●
	AM3HDCYN	Cylindrical Nozzle	19mm	3mm	Copper	●	●	●	●
	AM4HDTN	Tapered Nozzle	13mm	3mm	Copper	●	●	●	●
	AM4HDCN	Conical Nozzle	15mm	3mm	Copper	●	●	●	●
	AM4HDCYN	Cylindrical Nozzle	21mm	3mm	Copper	●	●	●	●
	AM5HDTN	Tapered Nozzle	13mm	3.5mm	Copper	●	●	●	●
	AM5HDCN	Conical Nozzle	15mm	3.5mm	Copper	●	●	●	●
	AM5HDCYN	Cylindrical Nozzle	21mm	3.5mm	Copper	●	●	●	●
	AM6HDTN	Tapered Nozzle	13mm	3.5mm	Copper	●	●	●	●
	AM6HDCN	Conical Nozzle	15mm	3.5mm	Copper	●	●	●	●
	AM6HDCYN	Cylindrical Nozzle	23mm	3.5mm	Copper	●	●	●	●
	AM3HDNI	Nozzle Insulator				●	●	●	●
	AM4HDNI	Nozzle Insulator				●	●	●	●
	AM5HDNI	Nozzle Insulator				●	●	●	●
	AM6HDNI	Nozzle Insulator				●	●	●	●

● Standard wear part range ● Torch package standard wear part set-up

Air-Cooled Nozzles - Single Piece

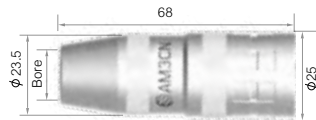

Part No.	Description	Bore	Wall	Material	M3	M4	M5	M6
AM3TN	Tapered Nozzle / Insulator Assy	12mm	2.25mm	Copper	●	●	●	●
AM3CN	Conical Nozzle / Insulator Assy	14mm	2.25mm	Copper	●	●	●	●
AM3CYN	Cylindrical Nozzle / Insulator Assy	19mm	2.25mm	Copper	●	●	●	●

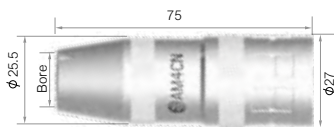

AM4TN	Tapered Nozzle / Insulator Assy	13mm	2.25mm	Copper	●	●	●	●
AM4CN	Conical Nozzle / Insulator Assy	15mm	2.25mm	Copper	●	●	●	●
AM4CYN	Cylindrical Nozzle / Insulator Assy	21mm	2.25mm	Copper	●	●	●	●

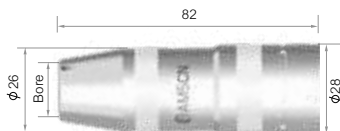

AM5TN	Tapered Nozzle / Insulator Assy	13mm	2.5mm	Copper	●	●	●	●
AM5CN	Conical Nozzle / Insulator Assy	15mm	2.5mm	Copper	●	●	●	●
AM5CYN	Cylindrical Nozzle / Insulator Assy	21mm	2.5mm	Copper	●	●	●	●

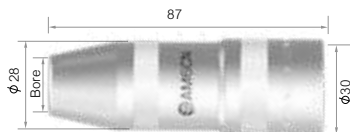

AM6TN	Tapered Nozzle / Insulator Assy	13mm	2.5mm	Copper	●	●	●	●
AM6CN	Conical Nozzle / Insulator Assy	15mm	2.5mm	Copper	●	●	●	●
AM6CYN	Cylindrical Nozzle / Insulator Assy	23mm	2.5mm	Copper	●	●	●	●

Liquid-Cooled Nozzles - Separate

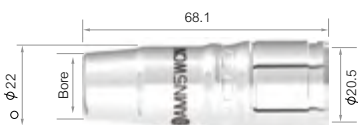

Part No.	Description	Bore	Wall	Material	M5W	M55W	M65W/WS	M65WLP	M65WA Auto
AMN5WCN	Conical / Insulator Assy	13.5mm	3.0mm	Copper	●	●	●	●	●
AMN5WTN	Tapered / Insulator Assy	11.5mm	3.0mm	Copper	●	●	●	●	●
AMN5WCYN	Cylindrical / Insulator Assy	16.0mm	3.0mm	Copper	●	●	●	●	●



AMN55WCN	Conical / Insulator Assy	15mm	3.0mm	Copper	●	●	●	●	●
AMN55WTN	Tapered / Insulator Assy	13mm	3.0mm	Copper	●	●	●	●	●
AMN55WCYN	Cylindrical / Insulator Assy	17mm	3.0mm	Copper	●	●	●	●	●

● Standard wear part range ● Torch package standard wear part set-up

Nozzle Retaining Rings

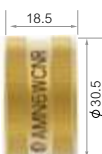
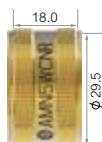

Part No.	Description	Size	Material	M5W	M55W	M65W/WS	M65WLP	M65WA Auto
AMN5WCNR	Nozzle Retaining Ring	29.5mm	Brass	●	●	●	●	●
AMN6WCNR	Nozzle Retaining Ring	30.5mm	Brass	●	●	●	●	●

Liquid-Cooled Nozzles -Complete



Part No.	Description	M5W	M55W	M65W/WS	M65WLP	M65WA Auto
AMN5WCN-C	Conical Nozzle c/w Insulator and Retaining Ring	●	●	●	●	●
AMN5WTN-C	Tapered Nozzle c/w Insulator and Retaining Ring	●	●	●	●	●
AMN5WCYN-C	Cylindrical Nozzle c/w Insulator and Retaining Ring	●	●	●	●	●
AMN55WCN-C	Conical Nozzle c/w Insulator and Retaining Ring	●	●	●	●	●
AMN55WTN-C	Tapered Nozzle c/w Insulator and Retaining Ring	●	●	●	●	●
AMN55WCYN-C	Cylindrical Nozzle c/w Insulator and Retaining Ring	●	●	●	●	●

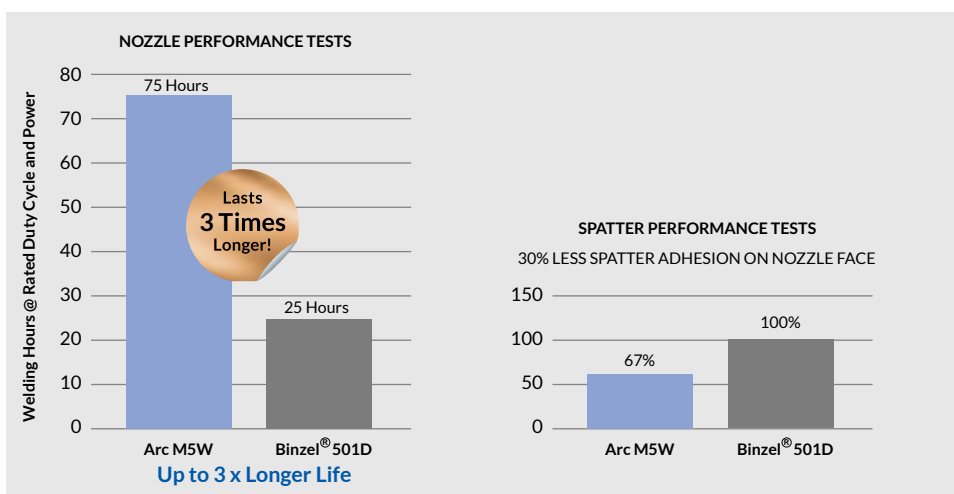

® All trademarks are the property of their respective owners and usage is for cross reference only

● Standard wear part range ● Torch package standard wear part set-up

WEAR PARTS

High Performance Series



MAKE WORK
LIFE EASIER

Contact Tips

M3 M4 M5 M6 M5W M55W M65W/WS M65WLP M65WA Auto
Air-Cooled Liquid-Cooled

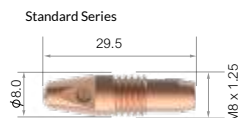

Part No.	Description	Size mm	Wire Size mm-Inch	Material	Wire Type	M3 Air-Cooled	M4	M5	M6	M5W Liquid-Cooled	M55W	M65W/WS	M65WLP	M65WA Auto
Standard Series - Recommended for Fe, Fe-MC/FC Set-up														
AM5CT09	Contact Tip	M8*29.5	0.9-0.035	CuCrZr	Fe, Fe-FC/MC SS,SS-FC/MC upto 1.2mm	●	●	●	●	●	●	●	●	●
AM5CT10	Contact Tip	M8*29.5	1.0-0.040	CuCrZr		●	●	●	●	●	●	●	●	●
AM5CT12	Contact Tip	M8*29.5	1.2-0.045	CuCrZr		●	●	●	●	●	●	●	●	●
AM5CT14	Contact Tip	M8*29.5	1.4-0.055	CuCrZr		●	●	●	●	●	●	●	●	●
AM5CT16	Contact Tip	M8*29.5	1.6-0.063	CuCrZr		●	●	●	●	●	●	●	●	●

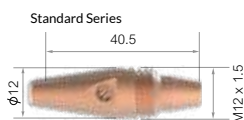

Standard Series - Recommended for Fe, Fe-MC/FC Set-up														
AM6CT09	Contact Tip	M12*40.5	0.9-0.035	CuCrZr	Fe, Fe-FC/MC SS,SS-FC/MC upto 1.2mm	●	●	●	●	●	●	●	●	●
AM6CT10	Contact Tip	M12*40.5	1.0-0.040	CuCrZr		●	●	●	●	●	●	●	●	●
AM6CT12	Contact Tip	M12*40.5	1.2-0.045	CuCrZr		●	●	●	●	●	●	●	●	●
AM6CT14	Contact Tip	M12*40.5	1.4-0.055	CuCrZr		●	●	●	●	●	●	●	●	●
AM6CT16	Contact Tip	M12*40.5	1.6-0.063	CuCrZr		●	●	●	●	●	●	●	●	●
AM6CT20	Contact Tip	M12*40.5	2.0-0.080	CuCrZr		●	●	●	●	●	●	●	●	●



Standard Series - Recommended for Fe, Fe-MC/FC Set-up														
AM6WCT09	Contact Tip	M10*35.5	0.9-0.035	CuCrZr	Fe, Fe-FC/MC SS,SS-FC/MC upto 1.2mm	●	●	●	●	●	●	●	●	●
AM6WCT10	Contact Tip	M10*35.5	1.0-0.040	CuCrZr		●	●	●	●	●	●	●	●	●
AM6WCT12	Contact Tip	M10*35.5	1.2-0.045	CuCrZr		●	●	●	●	●	●	●	●	●
AM6WCT14	Contact Tip	M10*35.5	1.4-0.055	CuCrZr		●	●	●	●	●	●	●	●	●
AM6WCT16	Contact Tip	M10*35.5	1.6-0.063	CuCrZr		●	●	●	●	●	●	●	●	●
AM6WCT20	Contact Tip	M10*35.5	2.0-0.080	CuCrZr		●	●	●	●	●	●	●	●	●

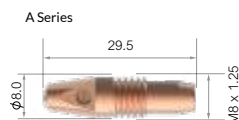

A Series - Recommended for Aluminium and SS Set-up														
AM5CT10A	Contact Tip	M8*29.5	1.0-0.040	CuCrZr	Aluminium SS, SS-FC/MC upto 1.6mm	●	●	●	●	●	●	●	●	●
AM5CT12A	Contact Tip	M8*29.5	1.2-0.045	CuCrZr		●	●	●	●	●	●	●	●	●
AM5CT16A	Contact Tip	M8*29.5	1.6-0.063	CuCrZr		●	●	●	●	●	●	●	●	●
AM2CT10A	Contact Tip	M8*29.5	1.0-0.040	Copper		●	●	●	●	●	●	●	●	●
AM2CT12A	Contact Tip	M8*29.5	1.2-0.045	Copper		●	●	●	●	●	●	●	●	●

● Standard wear part range ● Torch package standard wear part set-up

WEAR PARTS

High Performance Series



MAKE WORK
LIFE EASIER

Contact Tips

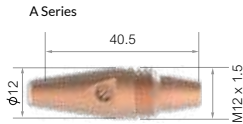

Part No.	Description	Size mm	Wire Size mm-inch	Material	Wire Type	M3 Air-Cooled	M4	M5	M6	M5W Liquid-Cooled	M55W	M65W/WS	M65WLP	M65WA Auto
A Series - Recommended for Aluminium and SS Set-up														
AM6CT10A	Contact Tip	M12*40.5	1.0-0.040	CuCrZr	Aluminium SS, SS-FC/MC upto 1.6mm	●	●	●	●	●	●	●	●	●
AM6CT12A	Contact Tip	M12*40.5	1.2-0.045	CuCrZr		●	●	●	●	●	●	●	●	●
AM6CT16A	Contact Tip	M12*40.5	1.6-0.063	CuCrZr		●	●	●	●	●	●	●	●	●
AM6CT20A	Contact Tip	M12*40.5	1.0-0.040	CuCrZr		●	●	●	●	●	●	●	●	●
AMC6CT10A	Contact Tip	M12*40.5	1.2-0.045	Copper		●	●	●	●	●	●	●	●	●
AMC6CT12A	Contact Tip	M12*40.5	2.0-0.080	Copper		●	●	●	●	●	●	●	●	●

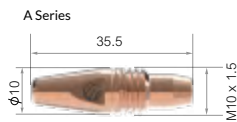

A Series - Recommended for Aluminium and SS Set-up														
AM6WCT10A	Contact Tip	M10*35.5	1.0-0.040	CuCrZr	Aluminium SS, SS-FC/MC 1.6mm	●	●	●	●	●	●	●	●	●
AM6WCT12A	Contact Tip	M10*35.5	1.2-0.045	CuCrZr		●	●	●	●	●	●	●	●	●
AM6WCT16A	Contact Tip	M10*35.5	1.6-0.063	CuCrZr		●	●	●	●	●	●	●	●	●
AM6WCT20A	Contact Tip	M10*35.5	2.0-0.080	CuCrZr		●	●	●	●	●	●	●	●	●
AMC6WCT10A	Contact Tip	M10*35.5	1.0-0.040	Copper		●	●	●	●	●	●	●	●	●
AMC6WCT12A	Contact Tip	M10*35.5	1.2-0.045	Copper		●	●	●	●	●	●	●	●	●

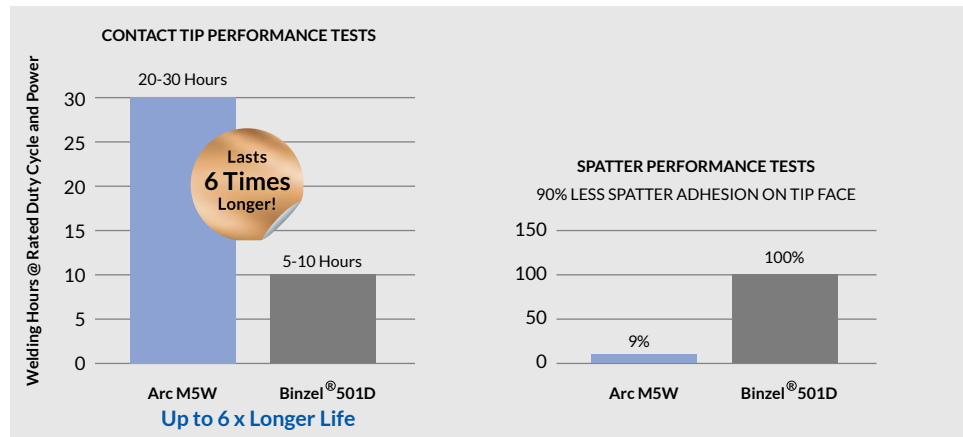

® All trademarks are the property of their respective owners and usage is for cross reference only

● Standard wear part range ● Torch package standard wear part set-up

The design, manufacturing and quality systems of Arc Torchology are certified by **BVQI** in accordance with EN/ISO 9001:2015

ARCTORCHOLOGY.COM

45

Tip Adaptors

M3 M4 M5 M6 M5W M55W M65W/WS M65WLP M65WA Auto
Air-Cooled Liquid-Cooled

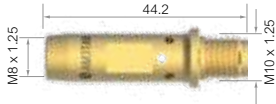

Part No.	Description	Length	Material	Transfer	Amps / Pulse	M3	M4	M5	M6	M5W	M55W	M65W/WS	M65WLP	M65WA Auto
Recommended for high amperages, high duty and pulse welding. Tips run cooler														
AM3TAC	Tip Adaptor High Performance	44.2mm	CuCrZr		High Current Pulse	●	●	●	●	●	●	●	●	●
AM3TAB	Tip Adaptor	44.2mm	Brass		Low Current Pulse	●	●	●	●	●	●	●	●	●

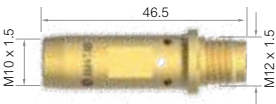

AM4TAC	Tip Adaptor High Performance	46.5mm	CuCrZr		High Current Pulse	●	●	●	●	●	●	●	●	●
AM4TAB	Tip Adaptor	46.5mm	Brass		Low Current Pulse	●	●	●	●	●	●	●	●	●



Recommended for high amperages, high duty and pulse welding. Tips run cooler														
AM5TAC	Tip Adaptor High Performance	51.7mm	CuCrZr		High Current Pulse	●	●	●	●	●	●	●	●	●
AM5TAB	Tip Adaptor	51.7mm	Brass		Low Current Pulse	●	●	●	●	●	●	●	●	●

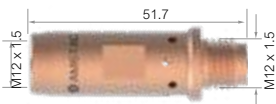

AM6TAC	Tip Adaptor High Performance	51.7mm	CuCrZr		High Current Pulse	●	●	●	●	●	●	●	●	●
AM6TAB	Tip Adaptor	51.7mm	Brass		Low Current Pulse	●	●	●	●	●	●	●	●	●



Recommended for high amperages, high duty and pulse welding. Tips run cooler														
AM5WTAC-20	High Performance 2.0mm Recess	34.5mm	Copper	Short Circuit	<200A Low Current Pulse	●	●	●	●	●	●	●	●	●
AM5WTAC-45	High Performance 4.5mm Recess	32mm	Copper	Spray	>200A High Current Pulse	●	●	●	●	●	●	●	●	●



AM5WTAB-20	Tip Adaptor 2.0mm Recess	34.5mm	Brass	Short Circuit	<200A Low Current Pulse	●	●	●	●	●	●	●	●	●
AM5WTAB-45	Tip Adaptor 4.5mm Recess	32mm	Brass	Spray	>200A High Current Pulse	●	●	●	●	●	●	●	●	●

● Standard wear part range ● Torch package standard wear part set-up

M3
M4
M5
M6
Air-Cooled

M5W
M55W
M65W/WS
M65WLP
M65WA Auto
Liquid-Cooled



Part No.	Description	Length	Material	Transfer	Amps / Pulse	M3 Air-Cooled	M4	M5	M6	M5 Liquid-Cooled	M6	M6
Recommended for high amperages, high duty and pulse welding. Tips run cooler												
AM6OSWTAC-20	High Performance 2.0mm Recess	36.0mm	Copper	Short Circuit	<200A Low Current Pulse	●	●	●	●	●	●	●
AM6OSWTAC-45	High Performance 4.5mm Recess	33.5mm	Copper	Spray	>200A High Current Pulse	●	●	●	●	●	●	●
AM6OSWTAB-20	Tip Adaptor 2.0mm Recess	36.0mm	Brass	Short Circuit	<200A Low Current Pulse	●	●	●	●	●	●	●
AM6OSWTAB-45	Tip Adaptor 4.5mm Recess	33.5mm	Brass	Spray	>200A High Current Pulse	●	●	●	●	●	●	●

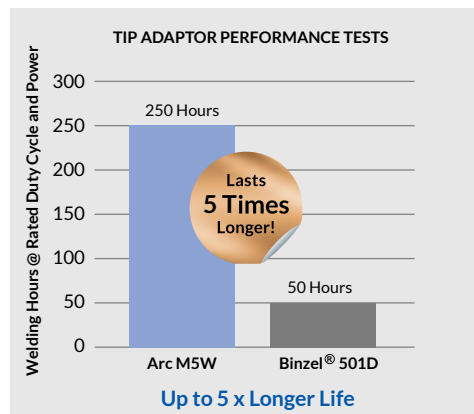

Tip Adaptor Insulators

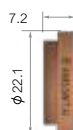
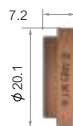

Part No.	Description	M3 Air-Cooled	M4	M5	M6	M51 Liquid-Cooled	M52	M63	M65	M65
AM5WTAI	Tip Adaptor Insulator	●	●	●	●	●	●	●	●	●
AM55WTAI	Tip Adaptor Insulator	●	●	●	●	●	●	●	●	●

47

WEAR PARTS

High Performance Series



MAKE WORK
LIFE EASIER

Liners

Filler Metal

Steel Liner Recommended for: Fe, Fe-MC/FC. Light and medium duty applications

Part No.	Description	Nipple	Wire Size mm	M3 Air-Cooled	M4	M5	M6	M5W Liquid-Cooled	M55W	M65W/WS	M65WLP	M65WA Auto
AM1535-30	Steel Liner x 3mt	Moulded Nipple	0.6-0.9	●	●	●	●	●	●	●	●	●
AM1535-40	Steel Liner x 4mt	Moulded Nipple	0.6-0.9	●	●	●	●	●	●	●	●	●
AM1535-50	Steel Liner x 5mt	Moulded Nipple	0.6-0.9	●	●	●	●	●	●	●	●	●



AM2524-30	Steel Liner x 3mt	Moulded Nipple	1.0-1.2	●	●	●	●	●	●	●	●	●
AM2524-40	Steel Liner x 4mt	Moulded Nipple	1.0-1.2	●	●	●	●	●	●	●	●	●
AM2524-50	Steel Liner x 5mt	Moulded Nipple	1.0-1.2	●	●	●	●	●	●	●	●	●



Filler Metal Fe, Fe-MC/FC

Steel Liner Recommended for: Light and medium duty applications

Part No.	Description	Contact Tip	Wire Size mm	M3 Air-Cooled	M4	M5	M6	M5W Liquid-Cooled	M55W	M65W/WS	M65WLP	M65WA Auto
AM6SL-1012-20	Steel Liner x 2mt	Standard Series	1.0-1.2	●	●	●	●	●	●	●	●	●
AM6SL-1012-30	Steel Liner x 3mt	Standard Series	1.0-1.2	●	●	●	●	●	●	●	●	●
AM6SL-1012-40	Steel Liner x 4mt	Standard Series	1.0-1.2	●	●	●	●	●	●	●	●	●
AM6SL-1012-50	Steel Liner x 5mt	Standard Series	1.0-1.2	●	●	●	●	●	●	●	●	●



AM6SL-16-20	Steel Liner x 2mt	Standard Series	1.6	●	●	●	●	●	●	●	●	●
AM6SL-16-30	Steel Liner x 3mt	Standard Series	1.6	●	●	●	●	●	●	●	●	●
AM6SL-16-40	Steel Liner x 4mt	Standard Series	1.6	●	●	●	●	●	●	●	●	●
AM6SL-16-50	Steel Liner x 5mt	Standard Series	1.6	●	●	●	●	●	●	●	●	●



AM6SL-20-20	Steel Liner x 2mt	Standard Series	2.0	●	●	●	●	●	●	●	●	●
AM6SL-20-30	Steel Liner x 3mt	Standard Series	2.0	●	●	●	●	●	●	●	●	●
AM6SL-20-40	Steel Liner x 4mt	Standard Series	2.0	●	●	●	●	●	●	●	●	●
AM6SL-20-50	Steel Liner x 5mt	Standard Series	2.0	●	●	●	●	●	●	●	●	●



● Standard wear part range ● Torch package standard wear part set-up

WEAR PARTS

High Performance Series



MAKE WORK
LIFE EASIER

Liners

Filler Metal ^{ss, ss-MC/FC}

Stainless Steel Liner Recommended for: Heavy Duty Fe. High amperages and heavy deposition welding

Part No.	Description	Contact Tip	Wire Size mm	M3 Air-Cooled	M4	M5	M6	M5W Liquid-Cooled	M55W	M65W/WS	M65WLP	M65WA Auto
AM6SSTL-1012-20	Stainless Steel Liner x 2mt	Standard Series	1.0-1.2	●	●	●	●	●	●	●	●	●
AM6SSTL-1012-30	Stainless Steel Liner x 3mt	Standard Series	1.0-1.2	●	●	●	●	●	●	●	●	●
AM6SSTL-1012-40	Stainless Steel Liner x 4mt	Standard Series	1.0-1.2	●	●	●	●	●	●	●	●	●
AM6SSTL-1012-50	Stainless Steel Liner x 5mt	Standard Series	1.0-1.2	●	●	●	●	●	●	●	●	●



AM6SSTL-16-20	Stainless Steel Liner x 2mt	A Series	1.6	●	●	●	●	●	●	●	●	●
AM6SSTL-16-30	Stainless Steel Liner x 3mt	A Series	1.6	●	●	●	●	●	●	●	●	●
AM6SSTL-16-40	Stainless Steel Liner x 4mt	A Series	1.6	●	●	●	●	●	●	●	●	●
AM6SSTL-16-50	Stainless Steel Liner x 5mt	A Series	1.6	●	●	●	●	●	●	●	●	●



Filler Metal ^{AlMg}

Al - Combi Liner Recommended for: Air-Cooled torches, Can be used for SS-MC/FC wires

Part No.	Description	Contact Tip	Wire Size mm	M3 Air-Cooled	M4	M5	M6	M5W Liquid-Cooled	M55W	M65W/WS	M65WLP	M65WA Auto
AM1564-30	Combi-Liner x 3mt	A Series	0.8-1.2	●	●	●	●	●	●	●	●	●
AM1564-40	Combi-Liner x 4mt	A Series	0.8-1.2	●	●	●	●	●	●	●	●	●
AM1564-50	Combi-Liner x 5mt	A Series	0.8-1.2	●	●	●	●	●	●	●	●	●



Al - Combi Liner Recommended for: Liquid-Cooled torches and frequent /repetitive arc starts

AM6CL-1012-20	Combi-Liner x 2mt	A Series	1.0-1.2	●	●	●	●	●	●	●	●	●
AM6CL-1012-30	Combi-Liner x 3mt	A Series	1.0-1.2	●	●	●	●	●	●	●	●	●
AM6CL-1012-40	Combi-Liner x 4mt	A Series	1.0-1.2	●	●	●	●	●	●	●	●	●
AM6CL-1012-50	Combi-Liner x 5mt	A Series	1.0-1.2	●	●	●	●	●	●	●	●	●



● Standard wear part range ● Torch package standard wear part set-up

The design, manufacturing and quality systems of Arc Torchology are certified by **BVQI** in accordance with EN/ISO 9001:2015

ARCTORCHOLOGY.COM

WEAR PARTS

High Performance Series



MAKE WORK
LIFE EASIER

Liners

Filler Metal ^{AlMg}

Al - Combi Liner Recommended for: Liquid-cooled torches and frequent /repetitive arc starts

Part No.	Description	Contact Tip	Wire Size mm	M3 Air-Cooled	M4	M5	M6	M5W Liquid-Cooled	M55W	M65W/WS	M65WLP	M65WA Auto
AM6CL-1620-20	Combi-Liner x 2mt	A Series	1.6	●	●	●	●	●	●	●	●	●
AM6CL-1620-30	Combi-Liner x 3mt	A Series	1.6	●	●	●	●	●	●	●	●	●
AM6CL-1620-40	Combi-Liner x 4mt	A Series	1.6	●	●	●	●	●	●	●	●	●
AM6CL-1620-50	Combi-Liner x 5mt	A Series	1.6	●	●	●	●	●	●	●	●	●



Filler Metal ^{AlMg}

Al - Soft Wire Liner Recommended for: Liquid-cooled torches, AlSi, Pure Al and copper wires

Part No.	Description	Contact Tip	Wire Size mm	M3 Air-Cooled	M4	M5	M6	M5W Liquid-Cooled	M55W	M65W/WS	M65WLP	M65WA Auto
AM6OSWL-1012-20	Soft Wire Liner x 3mt	A Series	1.0-1.2	●	●	●	●	●	●	●	●	●
AM6OSWL-1012-30	Soft Wire Liner x 3mt	A Series	1.0-1.2	●	●	●	●	●	●	●	●	●
AM6OSWL-1012-40	Soft Wire Liner x 4mt	A Series	1.0-1.2	●	●	●	●	●	●	●	●	●
AM6OSWL-1620-20	Soft Wire Liner x 2mt	A Series	1.6-2.0	●	●	●	●	●	●	●	●	●
AM6OSWL-1620-30	Soft Wire Liner x 3mt	A Series	1.6-2.0	●	●	●	●	●	●	●	●	●
AM6OSWL-1620-40	Soft Wire Liner x 4mt	A Series	1.6-2.0	●	●	●	●	●	●	●	●	●



AMOSW_LINER-T	Soft Wire / Combi-Liner Set-up Kit	●	●	●	●	●	●	●	●	●	●	●
---------------	------------------------------------	---	---	---	---	---	---	---	---	---	---	---



● Standard wear part range ● Torch package standard wear part set-up

SAY HELLO
TO OUR VISION OF THE FUTURE

Arc T

ARC M SERIES

Make Work Life Easier

MPA001 / 2023.08



MAKE WORK
LIFE EASIER